

JUMBO TEX®

WEATHER-RESISTIVE BARRIER

Part of a Complete Moisture Control System

Jumbo Tex is part of a complete Moisture Control System for walls engineered by the Fortifiber Building Systems Group®, which has been chosen by builders and architects to protect over *eight million* homes and commercial buildings from the problems caused by water intrusion and excessive moisture.

“Provides optimal breathability to prevent the potential for moisture condensation within exterior walls...”

Jumbo Tex is used in both production and custom residential construction where there is a need for a weather-resistant barrier that offers a balance between water protection and vapor permeability. The product delivers *two times* the water protection of standard Grade “D” paper, so it exceeds minimum code requirements while providing optimal breathability to prevent the potential for moisture condensation within exterior walls. As

important, it has the rugged durability necessary to resist tearing and puncturing on the jobsite. When integrated into the building envelope as part of a complete Moisture Control System, it helps eliminate moisture-related problems – including water-related structural failures, mold and mildew.

Unique Weather-Resistive Properties

The product is an asphalt-saturated building paper which delivers more predictable and consistent performance than felt-based solutions. Because it is manufactured from a base stock of kraft linerboard, Jumbo Tex is also far less brittle than felt – so it is less likely to tear during installation around corners and in tight conditions. Unlike some housewraps, it will retain its weather-resistive properties when exposed to either job site surfactants or wood extracts and tannin derivatives from wood siding.

The product’s 40 inch roll size makes it easier to install and store on the jobsite than other weather-resistive building materials. Jumbo Tex is also a very cost-effective solution. In fact, it is possible to pay three times more for other weather-resistive barriers that cannot surpass its reliable performance behind stucco, fiber cement siding, brick, vinyl and wood siding.



Decades of Proven Performance

Jumbo Tex is a product manufactured by the Fortifiber Building Systems Group. With more than a seventy-five year history of proven performance, technical expertise and practical know-how, the company has become a trusted partner to builders, architects and code officials.

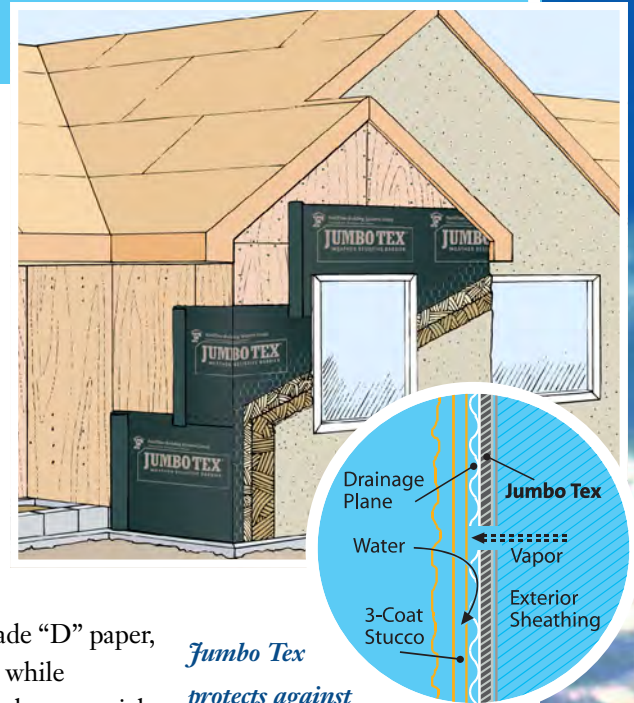

Jumbo Tex protects against water intrusion from the outside, while allowing moisture to escape from the inside.

- SOLID PROTECTION AGAINST MOISTURE PROBLEMS
- DEPENDABLE WATER RESISTANCE
- INCREDIBLE PRICE-PERFORMANCE
- IDEAL BALANCE BETWEEN WATER RESISTANCE AND PERMEABILITY
- RATED FOR ALL EXTERIOR CLADDINGS



Product Description: Jumbo Tex is a classic Grade “D” weather-resistive barrier designed for use behind a variety of exterior wall claddings. It provides excellent protection from internal wall damage due to moisture leakage and condensation.

Composition: Jumbo Tex is an asphalt-saturated kraft Grade “D” breather type sheathing paper.

Size & Weight: Jumbo Tex is supplied in 40" x 324 sq. ft. and 40" x 500 sq. ft. rolls. Product weight is approximately 3.6 lbs/100 sq. ft.

Applicable Standards: Exceeds Federal Specification UU-B-790a, Type 1, Grade “D”, Style 2.

Complies with the International Code Council Evaluation Services Acceptance Criteria for Water Resistive Barriers (AC 38).

Complies with the Uniform Building Code Standard 14-1.

Complies as an alternative to the water-resistive barrier specified in Section 1404.2 of the International Building Code®.

Complies as an alternative to the weather-resistant sheathing papers specified in Section R703.2 of the International Residential Code®.

ICC Evaluation Service Report 1027.

American Society for Testing & Materials (ASTM):

- *ASTM D779 - Standard Test Method for Water Resistance of Paper, Paperboard and Other Sheet Materials by the Dry Indicator Test Method*
- *ASTM D828 - Tensile Properties of Paper and Paperboard Using Constant-Rate-of-Elongation Apparatus*
- *ASTM E96 - Water Vapor Transmission of Materials*

Physical Properties: Jumbo Tex is continually tested in accordance with ASTM procedures. The values shown in Table 1 are typical values obtained in these tests.

Limitations: Product should be covered as soon as possible. Inspect product to insure it is free of any protrusions or damage which may detract from the weather-resistive barrier integrity. Holes, tears or punctures should be sealed

with Moistop® Sealant and Liquid Flashing or Fortifiber Sheathing Tape. This product is not recommended for horizontal, below grade or roofing applications.

Installation: Jumbo Tex should be installed in accordance with the local applicable building code. The International Residential Code Section R703.2 and Uniform Building Code Standard 14-1, section 1402.1, state that weather-resistive barriers should be applied horizontally, with the upper layers overlapping the lower layer by a minimum of 2" (3" is recommended), and all vertical joints should be lapped a minimum of 6". To ensure the integrity of the weather-resistive barrier system, Fortifiber strongly recommends the use of a Two-Ply Jumbo Tex product or two layers of a single ply Jumbo Tex product when used with a three-coat stucco system.

Availability: The Fortifiber Building Systems Group’s products are distributed nationwide. For product information and pricing, please call a Fortifiber distributor near you. If you need assistance locating a participating distributor, please call our Customer Service Department at 1-800-773-4777.

Fortifiber Warranty: This product may be eligible for Fortifiber’s FortiShield® 15 year warranty when used in conjunction with other Fortifiber products. Please see our website at www.fortifiber.com/warranty.htm for details.

Fortifiber Corporation warrants that its products are in compliance with their published specifications and are free from defects in materials and workmanship for a period of two years from the date of purchase. This warranty does not apply to loss due to abuse. Material found to be defective will be replaced at no charge by Fortifiber, but in no event shall Fortifiber be liable for any other costs or damages, including any labor costs.

THIS EXPRESS WARRANTY IS GIVEN IN LIEU OF AND EXCLUDES ALL OTHER EXPRESS OR IMPLIED WARRANTIES, INCLUDING BUT NOT LIMITED TO THE IMPLIED WARRANTIES OF MERCHANTABILITY AND FITNESS FOR A PARTICULAR PURPOSE. Fortifiber’s sole obligations under this warranty are as set forth herein. In no event shall Fortifiber be liable for any lost revenue or profits, direct, indirect, special, incidental or consequential damages of any kind.

SPECIFICATION SUMMARY: Provides secondary weather protection behind exterior cladding to prevent moisture penetration and condensation in exterior wall assemblies.

WEATHER-RESISTIVE BARRIER: Fortifiber/Jumbo Tex asphalt saturated kraft Grade “D” breather type sheathing paper, single ply.

REFERENCE SPECIFICATION: Federal Specification UU-B-790a, Type 1, Grade “D”, Style 2.

Table 1- Physical Properties

CHARACTERISTIC	TEST METHOD	RESULTS	INDUSTRY STANDARD
Water Vapor Transmission	ASTM E96 (A)	200 grams 29 perms (MVT)	35 grams (min.) 5 perms (MVT)
Water Resistance	ASTM D779	20 minutes	10 minutes
Tensile Strength	ASTM D828	MD - 70 lb. ^f /inch CD -29 lb. ^f /inch	MD - 20 lb. ^f /inch CD - 20 lb. ^f /inch



Fortifiber Building Systems Group®
Protecting Your World from the Elements®

1-800-773-4777 • www.fortifiber.com

© 2015 Fortifiber Building Systems Group. Fortifiber®, FortiShield®, Jumbo Tex®, Moistop® Sealant and Liquid Flashing and Protecting Your World from the Elements® are trademarks of Fortifiber Corporation. 12/15

SUPER JUMBO TEX®

WEATHER-RESISTIVE BARRIER

60
MINUTE

PREMIER

Part of a Complete Moisture Control System

Super Jumbo Tex 60 Minute is the industry's leading 60 Minute building paper, with an unmatched track record of performance in the field. It is a member of the Jumbo Tex product line that has been chosen by builders and architects to protect over *five million* homes and commercial buildings from the problems caused by water intrusion and excessive moisture.

Super Jumbo Tex 60 Minute is used in both production and custom residential construction where there is a need for a high

“*The industry's leading 60 Minute building paper; with an unmatched track record of performance in the field...*”

performance weather-resistant barrier. The product delivers over *six times* the water protection of standard Grade “D” paper, while providing optimal breathability, to prevent the potential for moisture condensation within exterior walls. As important, it has the rugged durability necessary to resist tearing and puncturing on the jobsite. The product is part of a complete

Moisture Control System for walls engineered by the Fortifiber Building Systems Group®, which helps manage and eliminate moisture-related problems – including water-related structural failures, mold and mildew.

Unique Weather-Resistive Properties

The product is an asphalt-saturated building paper, which delivers highly reliable performance in the real world. Because it is manufactured from a base stock of kraft linerboard, Jumbo Tex is far less brittle than felt – so it is less likely to tear during installation around corners and in tight conditions. Unlike some housewraps, it will retain its weather-resistive properties when exposed to either job site surfactants or wood extracts and tannin derivatives from wood siding.

The product's 40 inch roll size makes it easier to install and store on the jobsite than other weather-resistive building materials. It is also more cost-effective than most housewraps, while offering the most formidable defense against water intrusion and moisture problems. In fact, it is possible to pay in excess of three times more for other weather-resistive barriers that cannot surpass its reliable performance behind stucco, fiber cement siding, brick, vinyl and wood siding.

Decades of Proven Performance

Super Jumbo Tex 60 Minute is a product manufactured by the Fortifiber Building Systems Group. With more than a seventy-five year history of proven performance, technical expertise and practical know-how, the company has become a trusted partner to builders, architects and code officials.

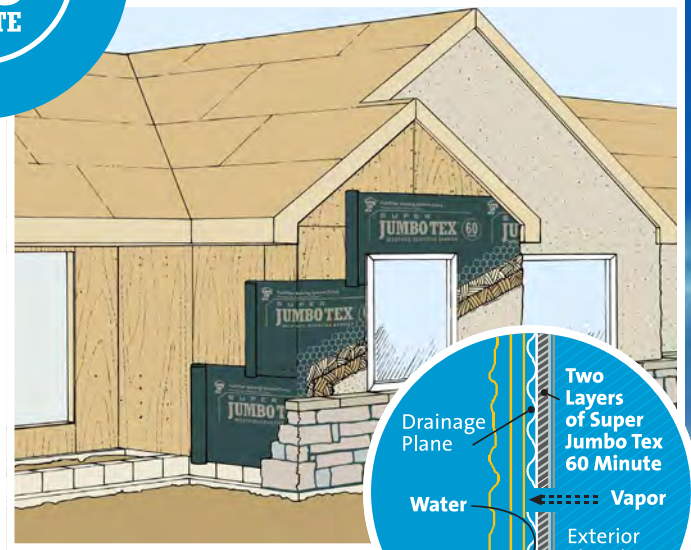

Super Jumbo Tex 60 Minute protects against water intrusion from the outside, while allowing moisture to escape from the inside.

- SOLID PROTECTION AGAINST MOISTURE PROBLEMS
- STRONG WATER RESISTANCE
- LOW VOC: MEETS CA 01350 FOR INDOOR AIR QUALITY
- EXCELLENT PRICE-PERFORMANCE
- IDEAL BALANCE BETWEEN WATER RESISTANCE AND PERMEABILITY
- FOR STUCCO, FIBER CEMENT SIDING, BRICK, VINYL AND WOOD SIDING
- REDUCES AIR INFILTRATION



Product Description: Super Jumbo Tex 60 Minute is a premier grade weather-resistive barrier designed for use within a variety of exterior wall assemblies. It provides excellent protection from internal wall damage due to water intrusion and condensation.

Composition: Super Jumbo Tex 60 Minute is an asphalt-saturated kraft Grade “D” breather type sheathing paper.

Size & Weight: Super Jumbo Tex 60 Minute is supplied in 40" x 240 sq. ft. and 40" x 324 sq. ft. rolls. Product weight is approximately 6 lbs/100 sq. ft.

Applicable Standards: Exceeds Federal Specification UU-B-790a, Type 1, Grade “D”, Style 2.

Complies with the International Code Council Evaluation Services Acceptance Criteria for Water Resistive Barriers (AC 38).

Complies with the Uniform Building Code Standard 14-1.

Complies as an alternative to the water-resistive barrier specified in Section 1404.2 of the International Building Code®.

Complies as an alternative to the weather-resistant sheathing papers specified in Section R703.2 of the International Residential Code®.

Passed: California Department of Health Standard 01350 for VOC emissions.

ICC Evaluation Service Report 1027.

American Society for Testing & Materials (ASTM):

- ASTM D-779 - Standard Test Method for Water Resistance of Paper, Paperboard and Other Sheet Materials by the Dry Indicator Test Method
- ASTM D-828 - Tensile Properties of Paper and Paperboard Using Constant-Rate-of-Elongation Apparatus
- ASTM E-96 - Water Vapor Transmission of Materials
- ASTM E-283 - Standard Test Method for Determining Rate of Air Leakage Through Exterior Windows, Curtain Walls, and Doors Under Specified Pressure Differences Across the Specimen
- ASTM E-1677 - Standard Specification for an Air Barrier Material

Physical Properties: Super Jumbo Tex 60 Minute is continually tested in accordance with ASTM procedures. The values shown in Table 1 are typical values obtained in these tests.

Limitations: Product should be covered as soon as possible.

Inspect product to insure it is free of any protrusions or damage which may detract from the weather-resistive barrier integrity. Holes, tears or punctures should be sealed with Moistop® Sealant or Fortifiber Sheathing Tape. This product is not recommended for horizontal, below grade or roofing applications.

Installation: Super Jumbo Tex 60 Minute should be installed in accordance with the local applicable building code. The International Residential Code Section R703.2 and Uniform Building Code Standard 14-1, section 1402.1, state that weather-resistive barriers should be applied horizontally, with the upper layers overlapping the lower layer by a minimum of 2" (3" is recommended), and all vertical joints should be lapped a minimum of 6". To ensure the integrity of the weather-resistive barrier system, Fortifiber strongly recommends the use of a Two-Ply Jumbo Tex product or two layers of a single ply Jumbo Tex product when used with a three-coat stucco system.

Availability: The Fortifiber Building Systems Group's products are distributed nationwide. For product information and pricing, please call a Fortifiber distributor near you. If you need assistance locating a participating distributor, please call our Customer Service Department at 1-800-773-4777.

Fortifiber Warranty: Fortifiber Corporation warrants that its products are in compliance with their published specifications and are free from defects in materials and workmanship for a period of two years from the date of purchase. This warranty does not apply to loss due to abuse. Material found to be defective will be replaced at no charge by Fortifiber, but in no event shall Fortifiber be liable for any other costs or damages, including any labor costs.

THIS EXPRESS WARRANTY IS GIVEN IN LIEU OF AND EXCLUDES ALL OTHER EXPRESS OR IMPLIED WARRANTIES, INCLUDING BUT NOT LIMITED TO THE IMPLIED WARRANTIES OF MERCHANTABILITY AND FITNESS FOR A PARTICULAR PURPOSE. Fortifiber's sole obligations under this warranty are as set forth herein. In no event shall Fortifiber be liable for any lost revenue or profits, direct, indirect, special, incidental or consequential damages of any kind.

This product may be eligible for Fortifiber's FortiShield 15 year warranty when used in conjunction with other Fortifiber products. Please see our website at www.fortifiber.com/warranty.htm for details.

SPECIFICATION SUMMARY: Provides secondary weather protection behind exterior cladding to prevent moisture penetration and condensation in exterior wall assemblies.

WEATHER-RESISTIVE BARRIER: Fortifiber/Super Jumbo Tex 60 Minute asphalt saturated kraft 60 minute Grade “D” breather type sheathing paper, single ply.

REFERENCE SPECIFICATION: Federal Specification UU-B-790a, Type 1, Grade “D”, Style 2.

Table 1- Physical Properties

CHARACTERISTIC	TEST METHOD	RESULTS	INDUSTRY STANDARD
Water Vapor Transmission	ASTM E-96 (A)	75 grams 11 perms (MVT)	35 grams (min.) 5 perms (MVT)
Water Resistance	ASTM D-779	>60 minutes	10 minutes
Tensile Strength	ASTM D-828	MD - 70 lb./inch CD - 60 lb./inch	MD - 20 lb./inch CD - 20 lb./inch
System Air Leakage	ASTM E-283	.02 CFM/ft ²	.06 CFM/ft ²
Low VOC	CA 01350	Pass	—



Fortifiber Building Systems Group®
Protecting Your World from the Elements®

Call 1-800-773-4777 or 1-775-333-6400 for sales and technical assistance. On the Internet visit www.fortifiber.com.

© 2015 Fortifiber Building Systems Group. Fortifiber®, FortiShield®, Jumbo Tex®, Moistop® Sealant and Protecting Your World from the Elements® are trademarks of Fortifiber Corporation. 12/15

TWO-PLY JUMBO TEX®

WEATHER-RESISTIVE BARRIER

PREMIER

Part of a Complete Moisture Control System

Two-Ply Jumbo Tex is a member of the Jumbo Tex family – a product line that has set the industry standard for effectiveness and durability as a weather-resistive barrier behind all major exterior wall claddings. It has been chosen by builders and architects to protect over *five million* homes and commercial buildings from the problems caused by water intrusion and excessive moisture.

“Provides the ideal balance between water protection and vapor permeability, to keep walls dry and homes comfortable...”

Two-Ply Jumbo Tex is engineered for production and custom residential construction applications that require a tough water and moisture barrier that offers outstanding water and moisture protection. It delivers over *ten times* the water resistance of regular Grade “D” building paper, while having the durability to endure rugged jobsite conditions. The product is part of a complete Moisture Control System for walls

engineered by the Fortifiber Building Systems Group®, which helps manage and eliminate moisture-related problems – including water-related structural failures, mold and mildew.

Two-Ply Jumbo Tex provides the ideal balance between water protection and vapor permeability, to keep walls dry and homes comfortable. The product also reduces air infiltration in exterior walls, contributing to energy savings.

Two-Ply Jumbo Tex is comprised of two layers of asphalt-saturated building paper, which is considered by many building science experts to provide the ideal drainage plane behind exterior claddings, and to increase the drying potential of the wall system when wet. Dual layers result in better sealing around attachment fasteners and better building envelope integration. Unlike some housewraps, it will retain its weather-resistive properties when exposed to either job site surfactants or wood extracts and tannin derivatives from wood siding.

Unique Weather-Resistive Properties

The product’s pliability and 40 inch wide roll size make it easier to install and store on the jobsite than other weather-resistive building materials. It is also a very cost-effective solution, while providing solid protection against water intrusion and moisture problems. When the code requires two layers of Grade “D” building paper, Two-Ply Jumbo Tex does the job in one pass, saving costly labor dollars. In fact, it is possible to pay up to three times more for other weather-resistive barriers that cannot surpass its reliable performance behind stucco, fiber cement siding, brick, vinyl and wood siding.

Decades of Proven Performance

Two-Ply Jumbo Tex is a product manufactured by the Fortifiber Building Systems Group. With more than a seventy-five year history of proven performance, technical expertise and practical know-how, the company has become a trusted partner to builders, architects and code officials.

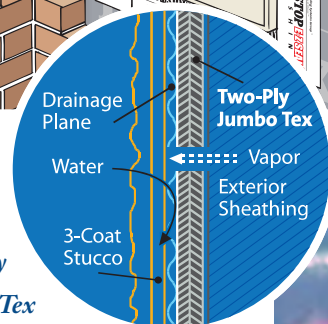
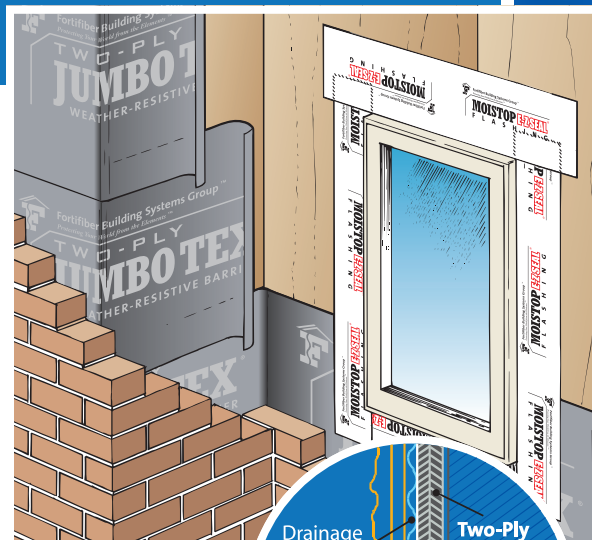

Two-Ply
Jumbo Tex

protects against water intrusion from the outside, while allowing moisture to escape from the inside.

- **SOLID PROTECTION AGAINST MOISTURE PROBLEMS**
- **EXCEPTIONAL WATER RESISTANCE**
- **SOLID PRICE-PERFORMANCE**
- **IDEAL BALANCE BETWEEN WATER RESISTANCE AND PERMEABILITY**
- **FOR STUCCO, FIBER CEMENT SIDING, BRICK, VINYL AND WOOD SIDING**
- **LABOR SAVINGS FOR TWO-PLY CODE REQUIREMENTS**



TWO-PLY JUMBO TEX

Product Description: Two-Ply Jumbo Tex is a premier grade weather-resistive barrier designed for use behind a variety of exterior wall claddings. It provides excellent protection from internal wall damage due to moisture leakage and condensation.

Composition: Two-Ply Jumbo Tex is an asphalt-saturated kraft Grade “D” breather type sheathing paper.

Size & Weight: Two-Ply Jumbo Tex is available in 40" x 162 sq. ft. and 40" x 250 sq. ft. rolls. Product weight is approximately 7.2 lbs/100 sq. ft.

Applicable Standards: Exceeds Federal Specification UU-B-790a, Type 1, Grade “D”, Style 2.

Complies with the International Code Council Evaluation Services Acceptance Criteria for Water Resistive Barriers (AC 38).

Complies with the Uniform Building Code Standard 14-1.

Complies as an alternative to the water-resistive barrier specified in Section 1404.2 of the International Building Code®.

Complies as an alternative to the weather-resistant sheathing papers specified in Section R703.2 of the International Residential Code®.

ICC Evaluation Service Report 1027.

American Society for Testing & Materials (ASTM):

- *ASTM D-779 - Standard Test Method for Water Resistance of Paper, Paperboard and Other Sheet Materials by the Dry Indicator Test Method*
- *ASTM D-828 - Tensile Properties of Paper and Paperboard Using Constant-Rate-of-Elongation Apparatus*
- *ASTM E-96 - Water Vapor Transmission of Materials*

Physical Properties: Two-Ply Jumbo Tex is continually tested in accordance with ASTM procedures. The values shown in Table 1 are typical values obtained in these tests.

Limitations: Product should be covered as soon as possible. Inspect product to insure it is free of any protrusions or damage which may detract from the weather-resistive barrier integrity. Holes, tears or punctures should be sealed with

Moistop® Sealant or Fortifiber Sheathing Tape. This product is not recommended for horizontal, below grade or roofing applications.

Installation: Two-Ply Jumbo Tex should be installed in accordance with the local applicable building code. The International Residential Code Section R703.2 and Uniform Building Code Standard 14-1, section 1402.1, state that weather-resistive barriers should be applied horizontally, with the upper layers overlapping the lower layer by a minimum of 2" (3" is recommended), and all vertical joints should be lapped a minimum of 6". To ensure the integrity of the weather-resistive barrier system, Fortifiber strongly recommends the use of a Two-Ply Jumbo Tex product or two layers of a single ply Jumbo Tex product when used with a three-coat stucco system. Do not tape horizontal or vertical seams.

Availability: The Fortifiber Building Systems Group's products are distributed nationwide. For product information and pricing, please call a Fortifiber distributor near you. If you need assistance locating a participating distributor, please call our Customer Service Department at 1-800-773-4777.

Fortifiber Warranty: Fortifiber Corporation warrants that its products are in compliance with their published specifications and are free from defects in materials and workmanship for a period of two years from the date of purchase. This warranty does not apply to loss due to abuse. Material found to be defective will be replaced at no charge by Fortifiber, but in no event shall Fortifiber be liable for any other costs or damages, including any labor costs.

THIS EXPRESS WARRANTY IS GIVEN IN LIEU OF AND EXCLUDES ALL OTHER EXPRESS OR IMPLIED WARRANTIES, INCLUDING BUT NOT LIMITED TO THE IMPLIED WARRANTIES OF MERCHANTABILITY AND FITNESS FOR A PARTICULAR PURPOSE.

Fortifiber's sole obligations under this warranty are as set forth herein. In no event shall Fortifiber be liable for any lost revenue or profits, direct, indirect, special, incidental or consequential damages of any kind.

This product may be eligible for Fortifiber's FortiShield 15 year warranty when used in conjunction with other Fortifiber products. Please see our website at www.fortifiber.com/warranty.htm for details.

SPECIFICATION SUMMARY: Provides secondary weather protection behind exterior cladding to prevent moisture penetration and condensation in exterior wall assemblies.

WEATHER-RESISTIVE BARRIER: Fortifiber/Two-Ply Jumbo Tex asphalt saturated kraft Grade “D” breather type sheathing paper.

REFERENCE SPECIFICATION: Federal Specification UU-B-790a, Type 1, Grade “D”, Style 2.

Table 1- Physical Properties

CHARACTERISTIC	TEST METHOD	RESULTS	INDUSTRY STANDARD
Water Vapor Transmission	ASTM E-96 (A)	95 grams 14 perms (MVT)	35 grams (min.) 5 perms (MVT)
Water Resistance	ASTM D-779	110 minutes	10 minutes per ply
Tensile Strength	ASTM D-828	MD - 144 lb. ^f /inch CD - 58 lb. ^f /inch	MD - 20 lb. ^f /inch CD - 20 lb. ^f /inch



Fortifiber Building Systems Group®
Protecting Your World from the Elements®

Call 1-800-773-4777 or 1-775-333-6400 for sales and technical assistance. On the Internet visit www.fortifiber.com.

© 2015 Fortifiber Building Systems Group. Fortifiber®, FortiShield®, Jumbo Tex®, Moistop® Sealant and Protecting Your World from the Elements® are trademarks of Fortifiber Corporation. 12/15

TWO-PLY SUPER JUMBO TEX[®]

WEATHER-RESISTIVE BARRIER

60
MINUTE

PROFESSIONAL

Part of a Complete Moisture Control System

Two-Ply Super Jumbo Tex 60 Minute is the flagship product of the Jumbo Tex family – a product line that has set the industry standard for effectiveness and durability as a weather-resistive barrier behind all major exterior wall claddings. It has been chosen by builders and architects to protect over *five million* homes and commercial buildings

“*Engineered for the most demanding residential and commercial construction applications that require maximum water and moisture protection...*”

from the problems caused by water intrusion and excessive moisture.

Two-Ply Super Jumbo Tex 60 Minute is engineered for residential and commercial construction applications that demand the maximum water and moisture protection available. Delivering over fifteen times the minimum water resistance requirement for Grade “D” paper, it has the toughness to

survive the most rugged of jobsites. The product is part of a complete Moisture Control System for walls engineered by the Fortifiber Building Systems Group[®], which helps manage and eliminate moisture-related problems – including water-related structural failures, mold and mildew.

Two-Ply Super Jumbo Tex 60 Minute provides the ideal balance between water protection and vapor permeability, to keep walls dry and homes comfortable. The product also reduces air infiltration in exterior walls, contributing to energy savings.

Two-Ply Super Jumbo Tex 60 Minute is comprised of two layers of asphalt-saturated building paper, which is considered by many building science experts to provide the ideal drainage plane behind exterior claddings, and to increase the drying potential of the wall system when wet. Dual layers also result in better sealing around attachment fasteners and better building envelope integration. Unlike some plastic housewraps, it will retain its weather-resistive properties when exposed to either jobsite surfactants or wood extracts and tannin derivatives from wood siding.

Unique Weather-Resistive Properties

The product’s pliability and 40 inch wide roll size make it easier to install and store on the jobsite than other weather-resistive building materials. It is also more cost-effective than plastic housewraps, while offering the most formidable defense against water intrusion and moisture problems. When the code requires two layers of Grade “D” building paper, Two-Ply Super Jumbo Tex 60 Minute does the job in one pass, saving costly labor dollars. In addition, it outperforms plastic housewraps in protecting against water intrusion – while providing vapor permeability behind stucco, fiber cement siding, brick, vinyl and wood siding.

Decades of Proven Performance

Two-Ply Super Jumbo Tex 60 Minute is a product manufactured by the Fortifiber Building Systems Group. With more than a seventy-five year history of proven performance, technical expertise and practical know-how, the company has become a trusted partner to builders, architects and code officials.

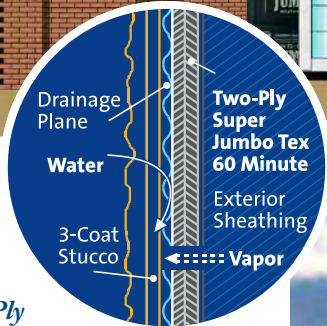

Two-Ply

Super Jumbo Tex

60 Minute protects against

water intrusion from the

outside, while allowing moisture

to escape from the inside.

- THE MOST FORMIDABLE DEFENSE AGAINST MOISTURE PROBLEMS
- EXCEPTIONAL WATER RESISTANCE
- EXCELLENT PRICE-PERFORMANCE
- BREATHABLE WEATHER-RESISTIVE BARRIER
- FOR STUCCO, FIBER CEMENT SIDING, BRICK, VINYL AND WOOD SIDING
- LABOR SAVINGS FOR TWO-PLY CODE REQUIREMENTS
- REDUCES AIR INFILTRATION



TWO-PLY SUPER JUMBO TEX 60 MINUTE

Product Description: Two-Ply Super Jumbo Tex 60 Minute is a professional grade weather-resistive barrier designed for use within a variety of exterior wall assemblies. It provides excellent protection from internal wall damage due to water intrusion and condensation.

Composition: Two-Ply Super Jumbo Tex 60 Minute is an asphalt-saturated kraft Grade “D” breather type sheathing paper.

Size & Weight: Two-Ply Super Jumbo Tex 60 Minute is available in 40" x 162 sq. ft. rolls. Product weight is approximately 12 lbs/100 sq. ft.

Applicable Standards: Exceeds Federal Specification UU-B-790a, Type 1, Grade “D”, Style 2.

Complies with the International Code Council Evaluation Services Acceptance Criteria for Water Resistive Barriers (AC 38).

Complies with the Uniform Building Code Standard 14-1.

Complies as an alternative to the water-resistive barrier specified in Section 1404.2 of the International Building Code®.

Complies as an alternative to the weather-resistant sheathing papers specified in Section R703.2 of the International Residential Code®.

ICC Evaluation Service Report 1027.

American Society for Testing & Materials (ASTM):

- *ASTM D-779 - Standard Test Method for Water Resistance of Paper, Paperboard and Other Sheet Materials by the Dry Indicator Test Method*
- *ASTM D-828 - Tensile Properties of Paper and Paperboard Using Constant-Rate-of-Elongation Apparatus*
- *ASTM E-96 - Water Vapor Transmission of Materials*

Physical Properties: Two-Ply Super Jumbo Tex 60 Minute is continually tested in accordance with ASTM procedures. The values shown in Table 1 are averages obtained in these tests.

Limitations: Product should be covered as soon as possible. Inspect product to insure it is free of any protrusions or damage which may detract from the weather-resistive

barrier integrity. Holes, tears or punctures should be sealed with Moistop® Sealant or Fortifiber Sheathing Tape. This product is not recommended for horizontal, roofing or below grade applications.

Installation: Two-Ply Super Jumbo Tex 60 Minute should be installed in accordance with the local applicable building code. The International Residential Code, Section R703.2, states that weather-resistive barriers should be applied horizontally, with the upper layers overlapping the lower layer by a minimum of 2" (3" is recommended), and all vertical joints should be lapped a minimum of 6". To ensure the integrity of the weather-resistive barrier system, Fortifiber strongly recommends the use of a Two-Ply Jumbo Tex product or two layers of a single ply Jumbo Tex product when used with a three-coat stucco system. Do not tape horizontal or vertical seams.

Availability: The Fortifiber Building Systems Group's products are distributed nationwide. For product information and pricing, please call a Fortifiber distributor near you. If you need assistance locating a participating distributor, please call our Customer Service Department at 1-800-773-4777.

Fortifiber Warranty: Fortifiber Corporation warrants that its products are in compliance with their published specifications and are free from defects in materials and workmanship for a period of two years from the date of purchase. This warranty does not apply to loss due to abuse. Material found to be defective will be replaced at no charge by Fortifiber, but in no event shall Fortifiber be liable for any other costs or damages, including any labor costs.

THIS EXPRESS WARRANTY IS GIVEN IN LIEU OF AND EXCLUDES ALL OTHER EXPRESS OR IMPLIED WARRANTIES, INCLUDING BUT NOT LIMITED TO THE IMPLIED WARRANTIES OF MERCHANTABILITY AND FITNESS FOR A PARTICULAR PURPOSE. Fortifiber's sole obligations under this warranty are as set forth herein. In no event shall Fortifiber be liable for any lost revenue or profits, direct, indirect, special, incidental or consequential damages of any kind.

This product may be eligible for Fortifiber's FortiShield 15 year warranty when used in conjunction with other Fortifiber products. Please see our website at www.fortifiber.com/warranty.htm for details.

SPECIFICATION SUMMARY: Provides secondary weather protection behind exterior cladding to prevent moisture penetration and condensation in exterior wall assemblies.

WEATHER-RESISTIVE BARRIER: Fortifiber/Two-Ply Super Jumbo Tex 60 Minute asphalt saturated kraft 60 minute Grade “D” breather type sheathing paper.

REFERENCE SPECIFICATION: Federal Specification UU-B-790a, Type 1, Grade “D”, Style 2.

Table 1- Physical Properties

CHARACTERISTIC	TEST METHOD	RESULTS	INDUSTRY STANDARD
Water Vapor Transmission	ASTM E-96 (A)	67 grams 10 perms (MVT)	35 grams (min.) 5 perms (MVT)
Water Resistance	ASTM D-779	150 minutes	10 minutes per ply
Tensile Strength	ASTM D-828	MD - 160 lb. ^f /inch CD - 110 lb. ^f /inch	MD - 20 lb. ^f /inch CD - 20 lb. ^f /inch



Fortifiber Building Systems Group®
Protecting Your World from the Elements®

Call 1-800-773-4777 or 1-775-333-6400 for sales and technical assistance. On the Internet visit www.fortifiber.com.

© 2015 Fortifiber Building Systems Group. Fortifiber®, FortiShield®, Jumbo Tex®, Moistop® Sealant and Protecting Your World from the Elements® are trademarks of Fortifiber Corporation. 12/15

TWO-PLY HYDROTEX™ DRAINABLE WRB

Part of a Complete Moisture Control System

Meeting the need for new, innovative product solutions to help protect homes and commercial buildings from the effects of water intrusion, Fortifiber has raised the bar again with its improved version of Hydro Tex™, increasing its drainage efficiency to an industry leading 95%.

“*The Hydro Tex design delivers outstanding water holdout with a balanced perm rating...*”

Hydro Tex blends the proven performance of our Super Jumbo Tex 60 Minute® asphalt-saturated kraft paper with WeatherSmart® Drainable – packaged together into a single roll. Hydro Tex delivers substantially more drainage performance than a standard dual ply weather-resistive barrier. In fact, it exceeds the demanding code requirements for the State of Oregon (R703.1 Residential Specialty Code for weather-resistive barriers.)

The product is part of a complete Moisture Control System for walls engineered by the Fortifiber Building Systems Group®, which has been chosen by builders and architects to protect over *five million* homes and commercial buildings from the problems caused by water intrusion. When integrated into the building envelope, our products help manage and eliminate moisture-related problems – including water-related structural failures, mold and mildew.

The Jumbo Tex line has been the industry standard in asphalt saturated kraft for over sixty years, having helped invent the model for how WRBs should perform in a wall system. The WeatherSmart Drainable layer is a spunbond polypropylene fabric with a non-perforated breathable barrier layer incorporating patented technology that actually channels liquid away from the wall assembly and to the ground.

The Fusion of Two Superior Products

Hydro Tex builds upon Super Jumbo Tex's stellar performance qualities by adding a layer of the most advanced drainage wrap on the market, WeatherSmart Drainable. Now builders and architects can confidently choose Hydro Tex when a highly-efficient drainable weather-resistive barrier is required, without adding the considerable labor cost of wrapping the building twice.



Hydro Tex is a product manufactured by the Fortifiber Building Systems Group. With more than a seventy-five year history of proven performance, technical expertise and practical know-how, the company has become a trusted partner to builders, architects and code officials.

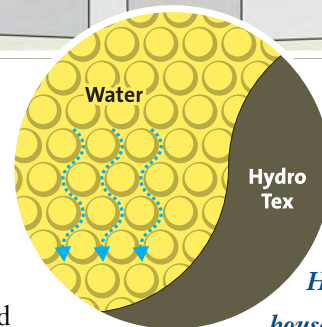

Hydro Tex housewrap's enhanced drainable pattern directs water out of the wall quickly.

- EXTRAORDINARY DRAINAGE PERFORMANCE
- EXCELLENT WATER RESISTANCE
- MEETS BUILDING SCIENCE RECOMMENDATIONS FOR BREATHABILITY
- LABOR SAVINGS FOR TWO-PLY CODE REQUIREMENTS
- NO NEED TO "MIX AND MATCH", ONE SOURCE, ONE WARRANTY



Product Description: Hydro Tex is a scientifically advanced housewrap combined with a professional Grade “D” building paper, designed for use within a variety of exterior wall assemblies. It provides excellent protection from wall damage due to water intrusion and condensation.

Composition: WeatherSmart Drainable is a spunbond polypropylene breathable fabric coated with a non-perforated breathable barrier layer. Super Jumbo Tex 60 Minute is an asphalt-saturated kraft Grade “D” breather type sheathing paper. These two products are combined to form Hydro Tex.

Size & Weight: Hydro Tex is available in 40" x 48.6' (162 sq. ft.) rolls. Product weight is approximately 7.4 lbs/100 sq. ft.

Applicable Standards: Complies with the International Code Council Evaluation Services Acceptance Criteria for Water Resistive Barriers (AC 38).

Complies as an alternative to the water-resistive barrier specified in Section 1404.2 of the International Building Code® (IBC).

Complies as an alternative to the weather-resistant sheathing papers specified in Section R703.2 of the International Residential Building Code® (IRC).

Complies with the two-layer weather-resistive barrier requirement of the Exceptions in Section 2510.6 of the IBC and Section R703.6.3 of the IRC. Each of the materials in Hydro Tex provides a water resistance equal to or greater than that of 60 minute Grade D paper.

ICC Evaluation Service Report 1027.

Complies with Oregon R703.1 Residential Specialty Code.

American Society for Testing & Materials (ASTM):

- ASTM D-779 - Standard Test Method for Water Resistance of Paper, Paperboard, and Other Sheet Materials by the Dry Indicator Method
- ASTM D-828 - Tensile Properties of Paper and Paperboard Using Constant-Rate-of-Elongation Apparatus
- ASTM E-96 - Standard Test Method for Water Vapor Transmission of Materials
- ASTM E-2273 - Standard Test Method for Determining the Drainage Efficiency of Exterior Insulation and Finish Systems (EIFS) Clad Wall Assemblies

Physical Properties: Hydro Tex is continually tested in accordance with ASTM procedures. The values shown in Table 1 are averages obtained in these tests.

Limitations: Product should be covered as soon as possible. Inspect product to insure it is free of any protrusions or damage which may detract from the weather-resistive barrier integrity. Holes, tears or punctures should be sealed with Moistop® Sealant or Fortifiber Sheathing Tape. This product is not recommended for horizontal, roofing or below grade applications.

Installation: Hydro Tex should be installed in accordance with the local applicable building code. Weather-resistive barriers should be applied horizontally, with the upper layers overlapping the lower layer by a minimum of 2" (3" is recommended), and all vertical joints should be lapped a minimum of 6". Ensure that the Super Jumbo Tex side (black layer) is installed to the outside. Do not tape horizontal or vertical seams.

Availability: The Fortifiber Building Systems Group's products are distributed nationwide. For product information and pricing, please call a Fortifiber distributor near you. If you need assistance locating a participating distributor, please call our Customer Service Department at 1-800-773-4777.

Fortifiber Warranty: Fortifiber Corporation warrants that its products are in compliance with their published specifications and are free from defects in materials and workmanship for a period of two years from the date of purchase. This warranty does not apply to loss due to abuse. Material found to be defective will be replaced at no charge by Fortifiber, but in no event shall Fortifiber be liable for any other costs or damages, including any labor costs.

THIS EXPRESS WARRANTY IS GIVEN IN LIEU OF AND EXCLUDES ALL OTHER EXPRESS OR IMPLIED WARRANTIES, INCLUDING BUT NOT LIMITED TO THE IMPLIED WARRANTIES OF MERCHANTABILITY AND FITNESS FOR A PARTICULAR PURPOSE.

Fortifiber's sole obligations under this warranty are as set forth herein. In no event shall Fortifiber be liable for any lost revenue or profits, direct, indirect, special, incidental or consequential damages of any kind.

This product may be eligible for Fortifiber's FortiShield 15 year warranty when used in conjunction with other Fortifiber products. Please see our website at www.fortifiber.com/warranty.htm for details.

SPECIFICATION SUMMARY: Provides secondary weather protection behind exterior cladding to prevent moisture penetration and condensation in exterior wall assemblies.

WEATHER-RESISTIVE BARRIER: Hydro Tex, a scientifically advanced housewrap combined with a professional grade building paper.

REFERENCE SPECIFICATION: Federal Specification UU-B-790a, Type 1, Grade “D”. International Code Council Evaluation Services Acceptance Criteria for Water Resistive Barriers (AC 38).

Table 1- Physical Properties

CHARACTERISTIC	TEST METHOD	RESULTS	INDUSTRY STANDARD
Moisture Vapor Transmission	ASTM E-96 Procedure A (Desiccant Method)	49.8 g/sm/day (7.6 perms)	35 g/sm/day (minimum) (5 perms)
Water Resistance “Boat Test”	ASTM D-779	>120 min	10 min (minimum)
Drainage Efficiency	ASTM E-2273	>95%	≥75%
Tensile Strength	ASTM D-828	MD - 70 lb./inch CD - 60 lb./inch	MD - 20 lb./inch CD - 20 lb./inch



Fortifiber Building Systems Group®
Protecting Your World from the Elements®

Call 1-800-773-4777 or 1-775-333-6400 for sales and technical assistance. On the Internet visit www.fortifiber.com.

© 2015 Fortifiber Building Systems Group. Fortifiber®, FortiShield®, Hydro Tex™, Moistop® Sealant, Protecting Your World from the Elements®, Super Jumbo Tex® and WeatherSmart® are trademarks of Fortifiber Corporation. 12/15

FORTIFIBER[®] SHEATHING TAPE

- **AGGRESSIVE, TACKY ADHESIVE AIDES IN SPLICING TO VARIOUS NON-SILICONE SURFACES.**
- **STRONG PET CARRIER ADDS DIMENSIONAL STABILITY AND STRENGTH.**
- **EXCELLENT BALANCE OF TACK, PEEL, AND TENSILE STRENGTH.**
- **MAINTAINS ADHESION AT LOW TEMPERATURES.**
- **EXHIBITS EXCELLENT AGING AND WEATHERING PROPERTIES.**
- **PROVIDES AN OUTSTANDING SEAM AND LAP SEAL.**
- **MAY BE APPLIED DOWN TO 10°F (-10°C).**
- **DESIGNED FOR USE WITH HYDRO TEX™, JUMBO TEX®, PLYDRY®, WEATHERSMART® AND WEATHER TEX® WEATHER RESISTIVE BARRIERS.**



Performance Properties: FORTIFIBER SHEATHING TAPE

Property	Fortifiber Sheathing Tape
Roll Dimensions	1 7/8" x 55 yards; 3" x 55 yards
Adhesive	Acrylic
Backing	Coated Polyester Film
Peel Adhesion (stainless steel)	20 oz./inch
Tensile Strength	37 lbs./inch
Elongation	110%



Fortifiber Building Systems Group[®]
Protecting Your World from the Elements[®]

Call 1-800-773-4777 or 1-775-333-6400
for sales and technical assistance.

On the Internet visit www.fortifiber.com.