

Installation Procedure

Last Updated: April 19, 2021

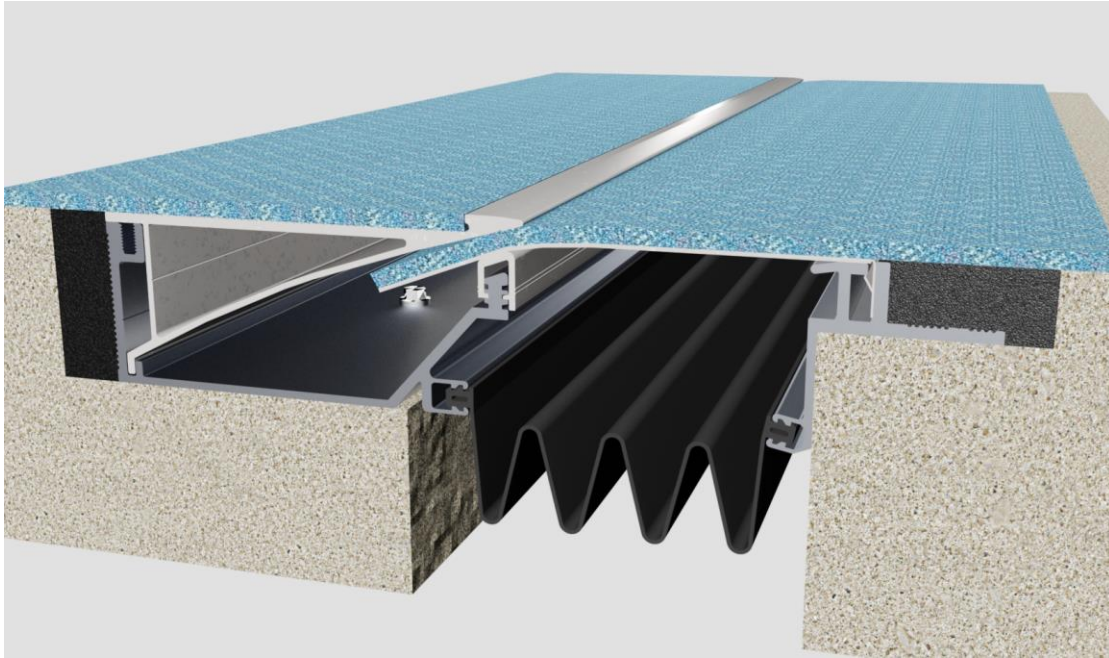

Wabo® Allure, AFJ 100-400

Interior Floor Seismic Expansion Control System

The following installation procedure is very important and must be fully understood prior to beginning any work. To ensure proper installation and performance of expansion joint system the following actions must be completed by the installing contractor. **Failure to do so will affect product warranty.**

- 1) Carefully read and understand installation procedure. Contact WBA's Technical Service Department at (800) 677-4922 for product assistance.
- 2) Inspect all shipments and materials for missing or damaged components and hardware. Contact Customer Service at (800) 677-4922 with WBA's order number and invoice for prompt assistance.
- 3) Inspect substrate or adjacent construction for acceptance before beginning work. Report unacceptable construction to the project manager for scheduled repair work.
- 4) Review WBA shop drawings for project specific detailed information if Engineering services were purchased at time of order.

Information provided herein, including but not limited to, any drawing, design, photograph, graphic, or statement(s) ("Materials") are proprietary and the property of Watson Bowman Acme ("Company"). Reproduction, translation, or reduction to any electronic medium or machine-readable form, in whole or part, is strictly prohibited, except for the express purpose for which it has been furnished, without prior written consent of Company. All Materials contained herein are provided by Company for information purposes only. Company reserves the right to amend or withdraw any information contained in the Materials without notice. All technical or other advice by Company, whether verbal or written, concerning products, or the use of products in specific situations ("Advice") is given by Company and is used at the User's own risk.

Health & Safety

During the installation of any Watson Bowman Acme product, appropriate personal protective items should be worn at all times, including but not limited to the following:

- Proper work clothing
- Safety glasses
- Safety boots
- Gloves
- Hard hat



Local rules and regulations regarding safe work environments and health should be followed.

Product Components

The following components are required for the installation of this product:



1/4" X 5/8" Csk
Flathead Machine
Screw
P/n: 5620

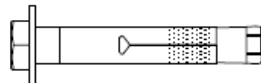

3/8" X 2-1/4" Anchor
P/n: 6514

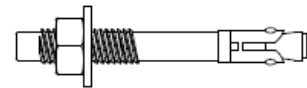

*1/4" X 2-1/4" Anchor
P/n: 6581



Aluminum Adjustable
Spring Support
P/n: 17035

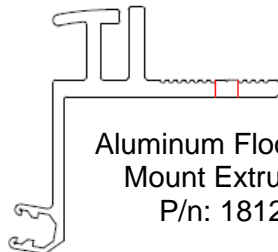

Aluminum Floor Leaf
Mount Extrusion
P/n: 18120

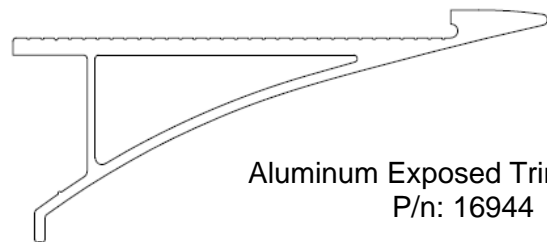

Aluminum Exposed Trim Surface
P/n: 16944



*Aluminum Wall
Mount Leaf
Extrusion P/n: 18044

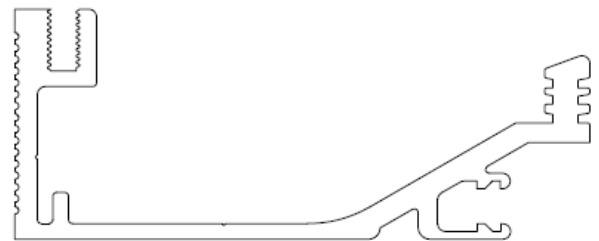

Aluminum Base Support P/n: 16943

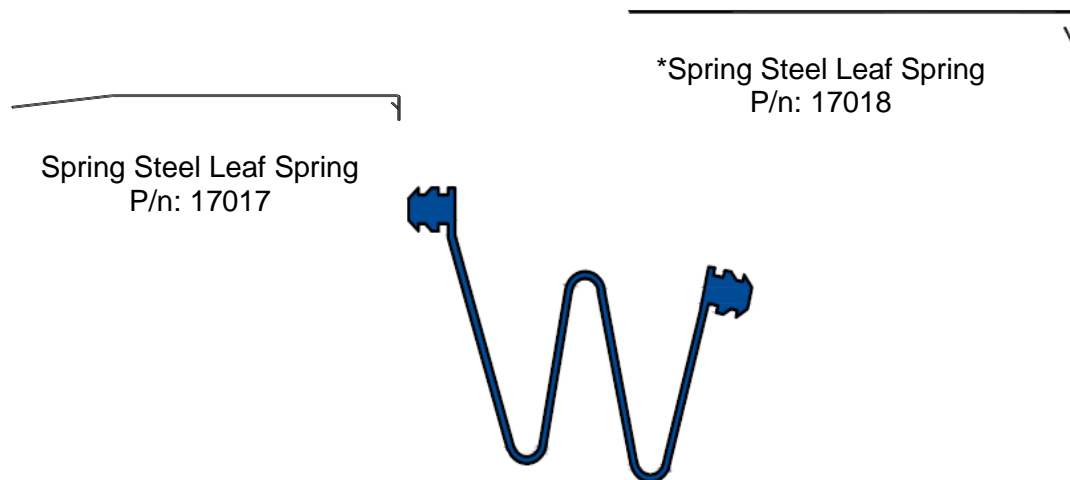

6" Functional Seal, Black PVC P/n: 1175
This component may vary in size depending on model of system

*Components required for corner condition installation

Installation

1

Prepare the concrete blockout for installation of expansion joint. Variations in blockout dimensions must be corrected prior to beginning work.

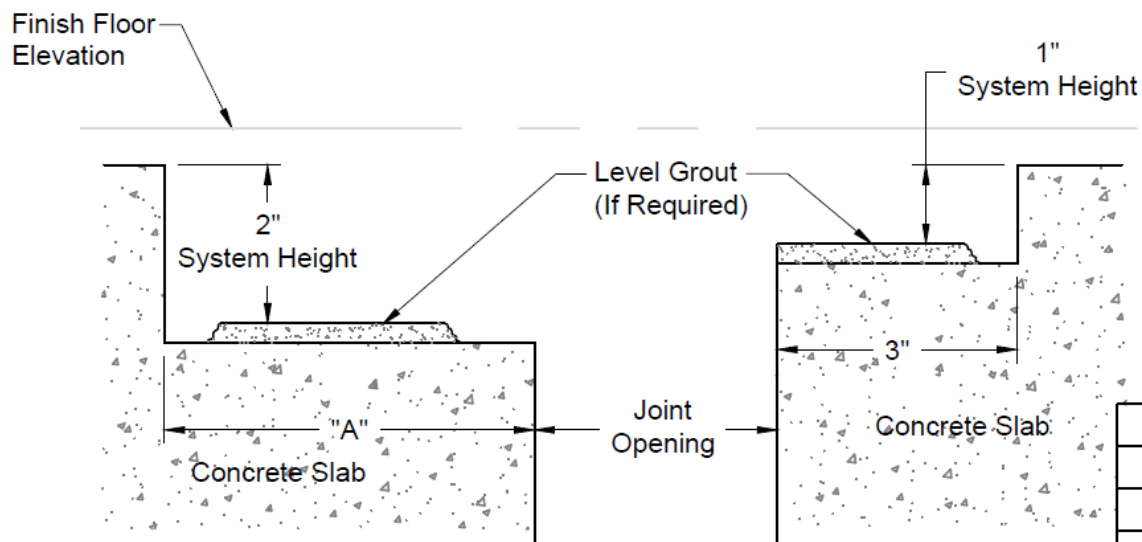

Dimension Chart	
Model	"A"
AFJ-100	7"
AFJ-200	6"
AFJ-400	4"

2

Floor - Position Aluminum Base Support and Aluminum Floor Leaf Mount Extrusion on blockout as shown. Mark anchor locations.

Note: Aluminum Base Support and Aluminum Floor Leaf Mount must have FULL BEARING on grout or slab.

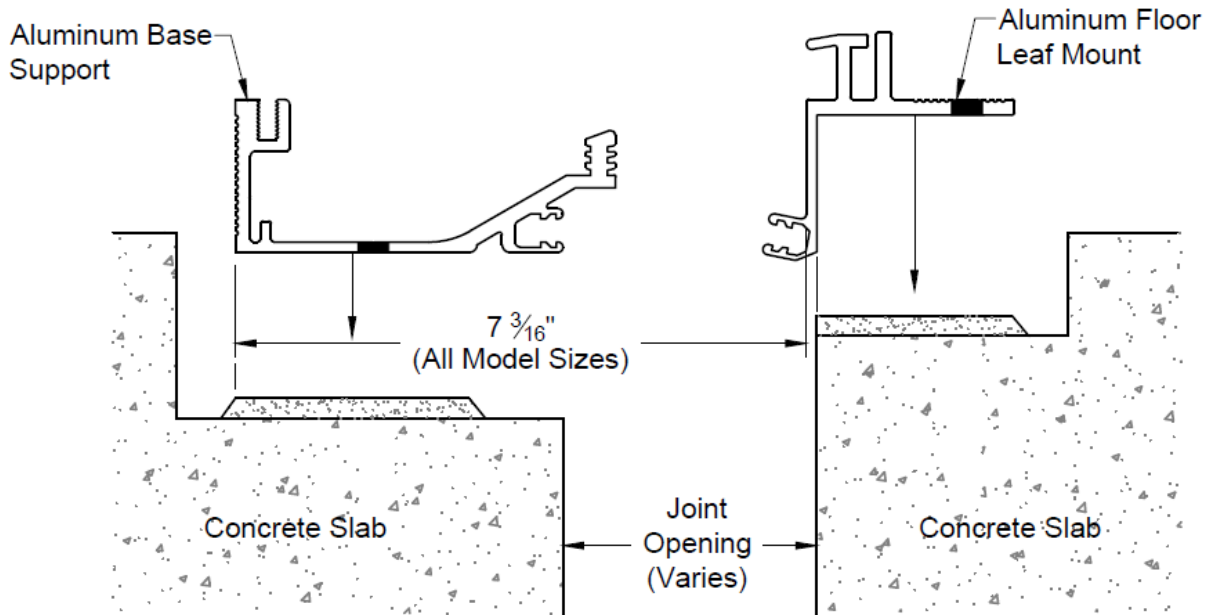

2A

Corner - Align top of Wall Leaf Mount Extrusion to $\frac{1}{8}"$ above top of Aluminum Base Member as shown. Mark anchor locations.

Note: Aluminum Base Support and Aluminum Floor Leaf Mount must have FULL BEARING on grout or slab.

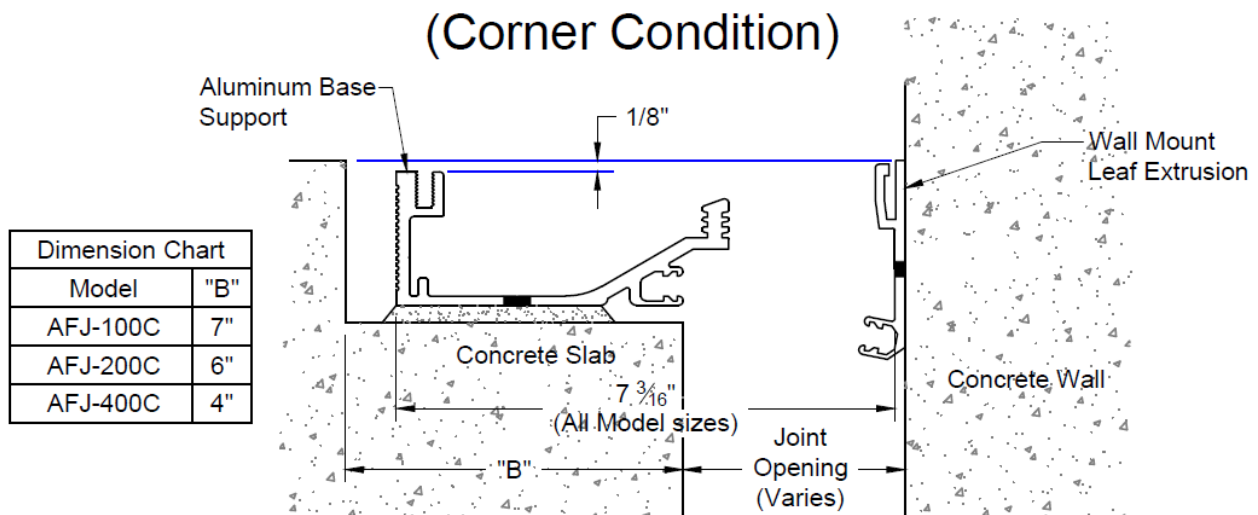

3

Drill holes for 3/8" x 2-1/4" anchor to proper depth. Clean out holes.

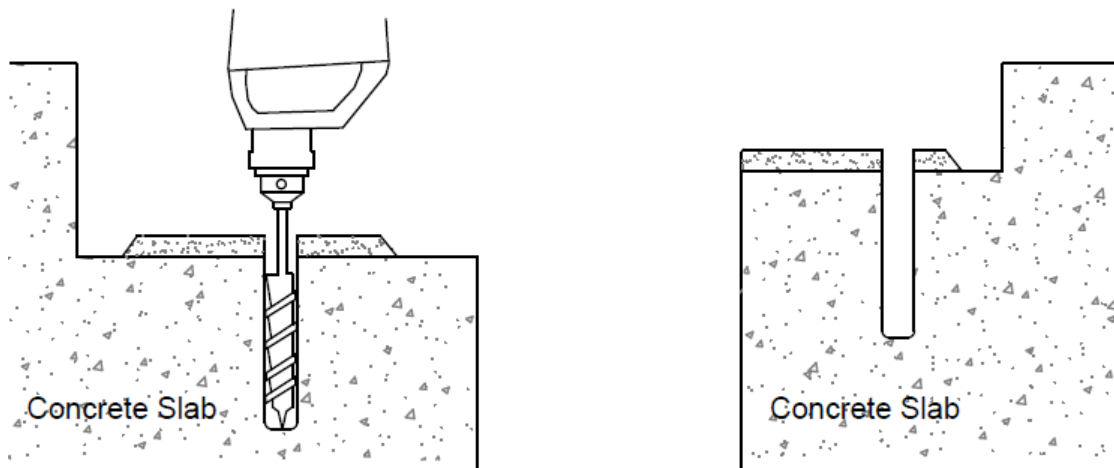
**4**

Floor - Slide spring support into proper slot of Aluminum Base Member. Adjust it according to the detail below, depending on floor covering being used. Then, utilizing manufacturer's anchors, mount and secure Aluminum Base Extrusion and Aluminum Floor Leaf Mount Extrusion to Concrete Slab.

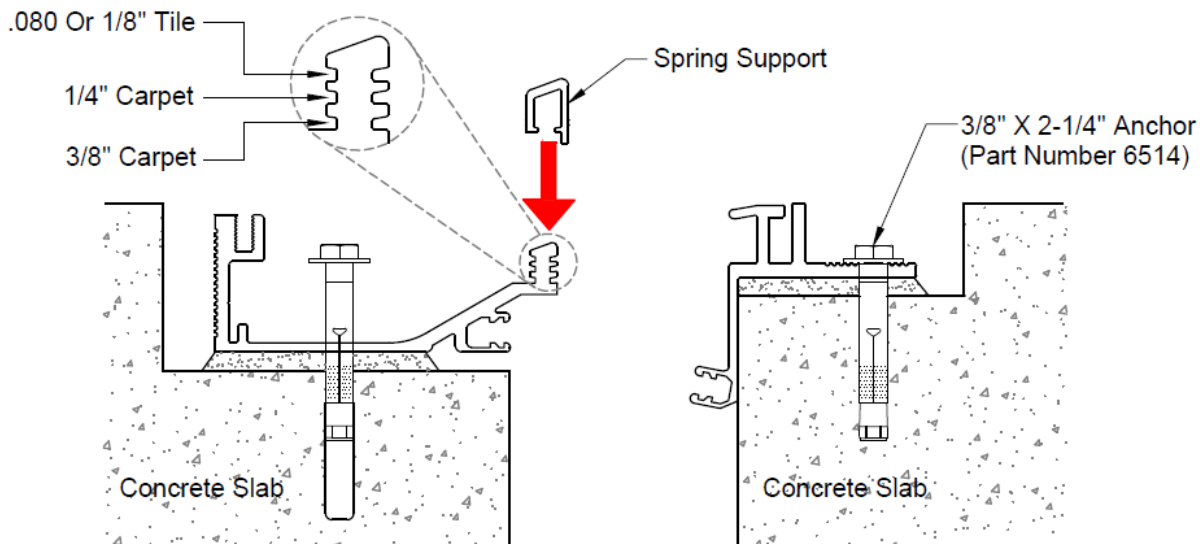
**4A**

Corner - Slide spring support into proper slot of Aluminum Base Member. Adjust it according to the detail below, depending on floor covering being used. Then, utilizing manufacturer's anchors, mount and secure Aluminum Base Extrusion and Aluminum Floor Leaf Mount Extrusion to Concrete Slab.

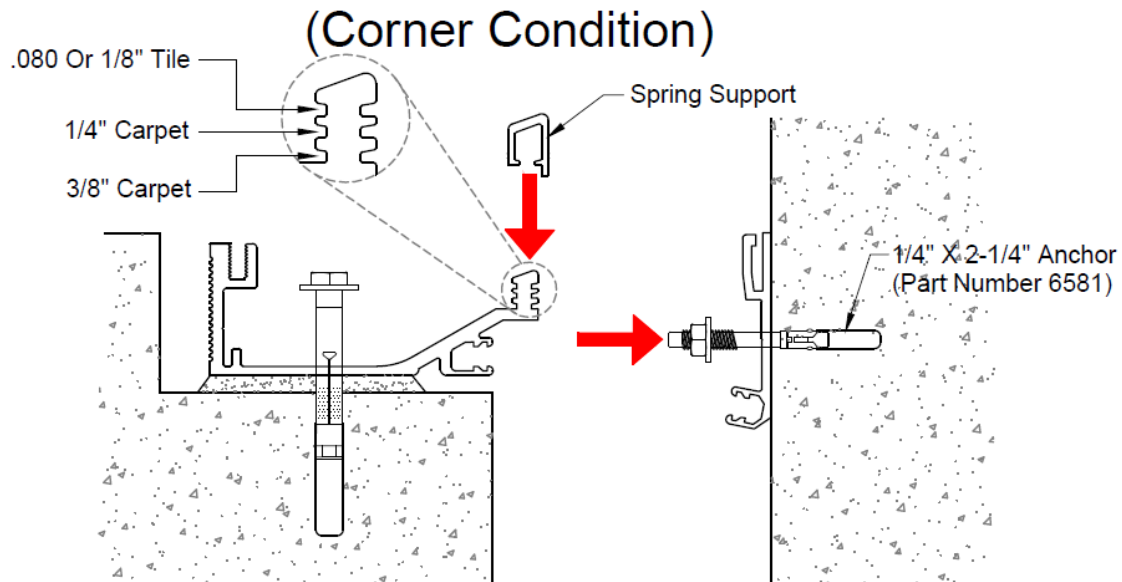

5

Stagger all splices in accordance with detail illustrated below to provide a stronger assembly and durable installation.

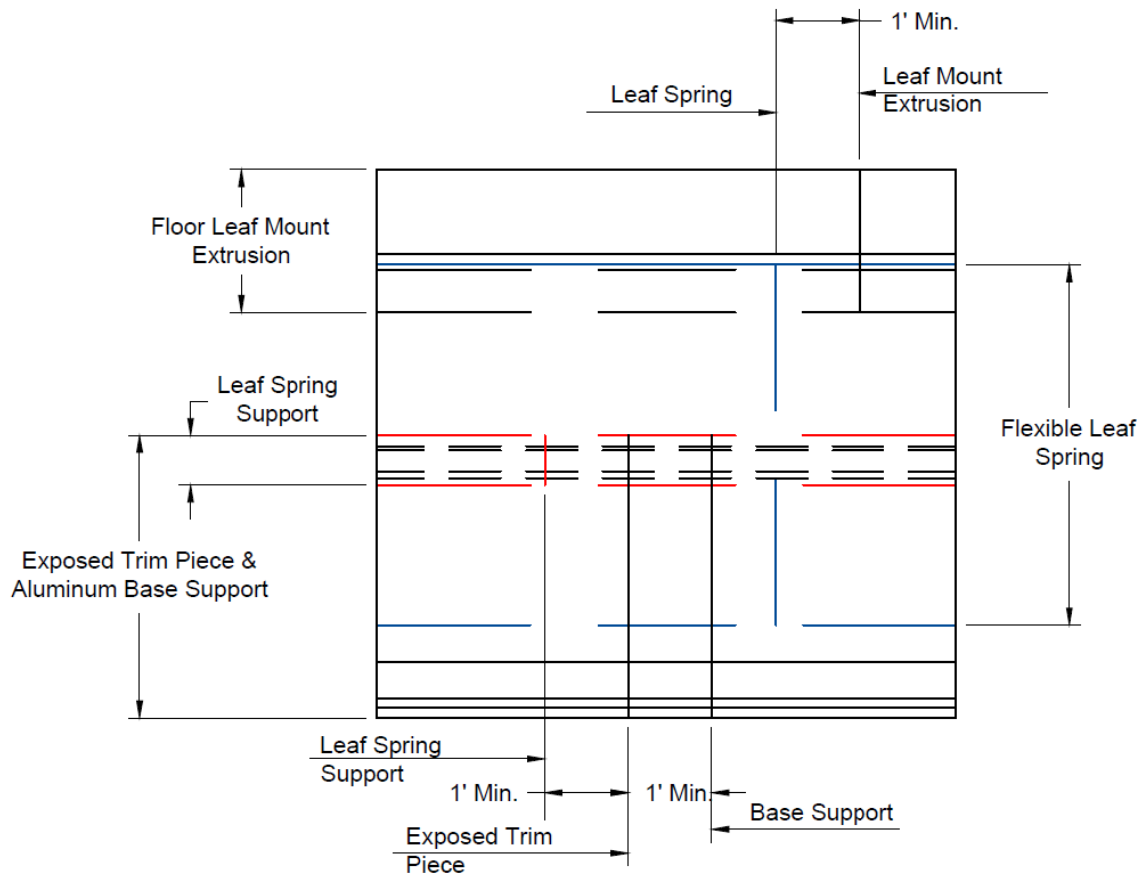

5A

Stagger all splices, in accordance with detail illustrated below, to provide a stronger assembly and durable installation (example #2).

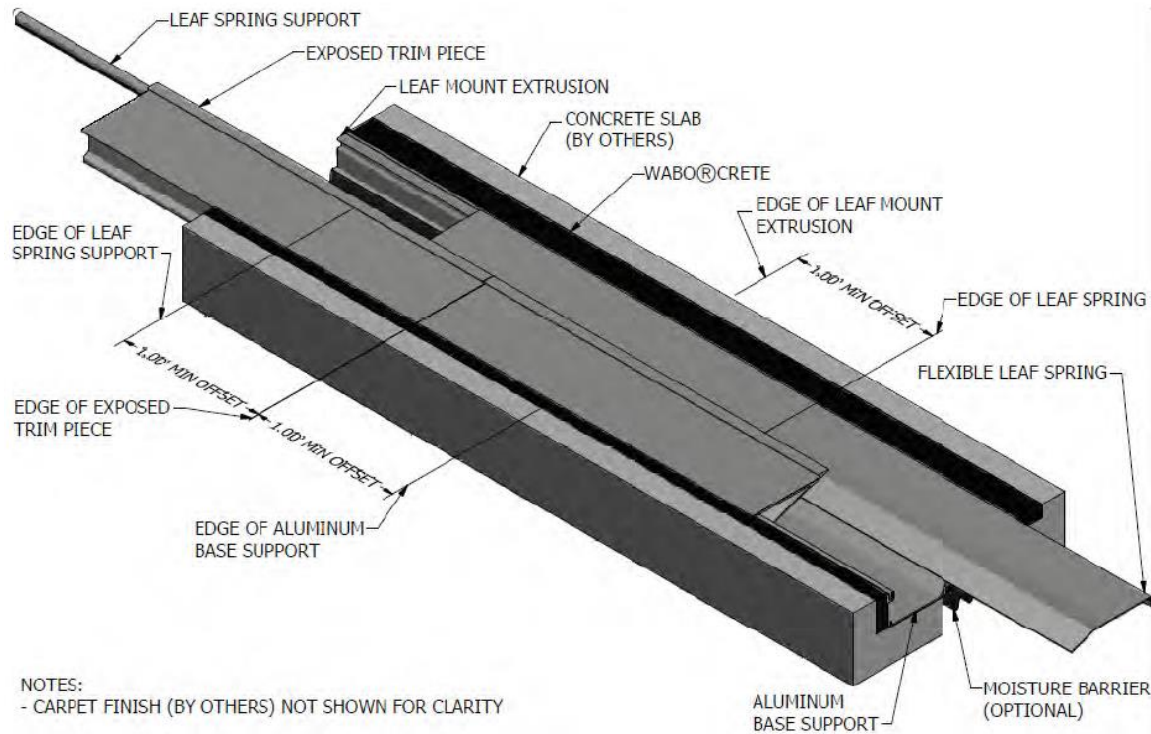

6

(Optional)

Brush-apply soapy water into extrusion cavity and install moisture barrier (if needed), exercising care not to damage moisture barrier. Ensure full engagement of locking lug.

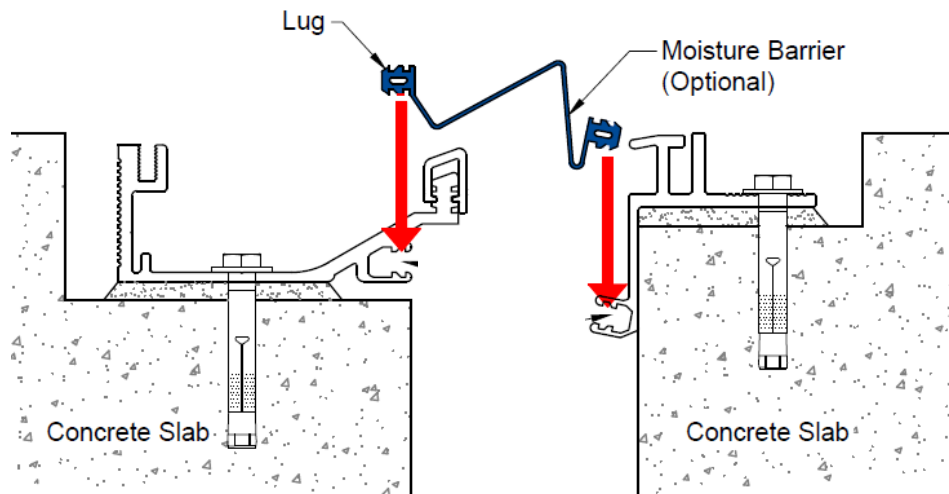

7

Snap Leaf Spring into Leaf Mount Extrusion. Ensure top surface of Leaf Mount Extrusion is flush with top surface of Leaf Spring.

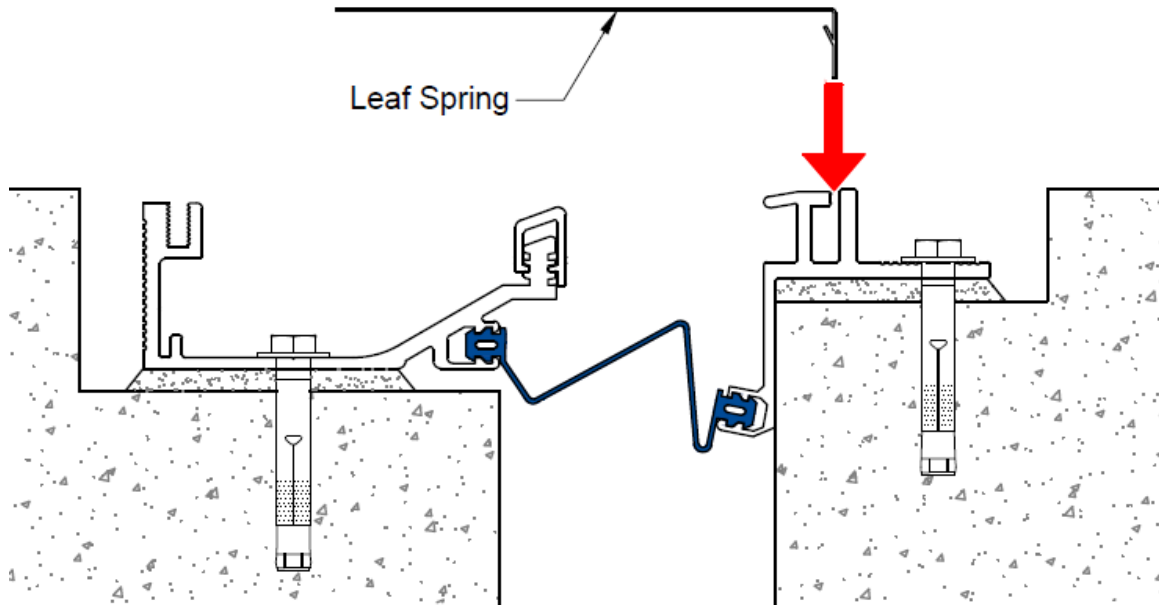

8

Stagger all splices, in accordance with detail illustrated below, to provide a stronger assembly and durable installation.

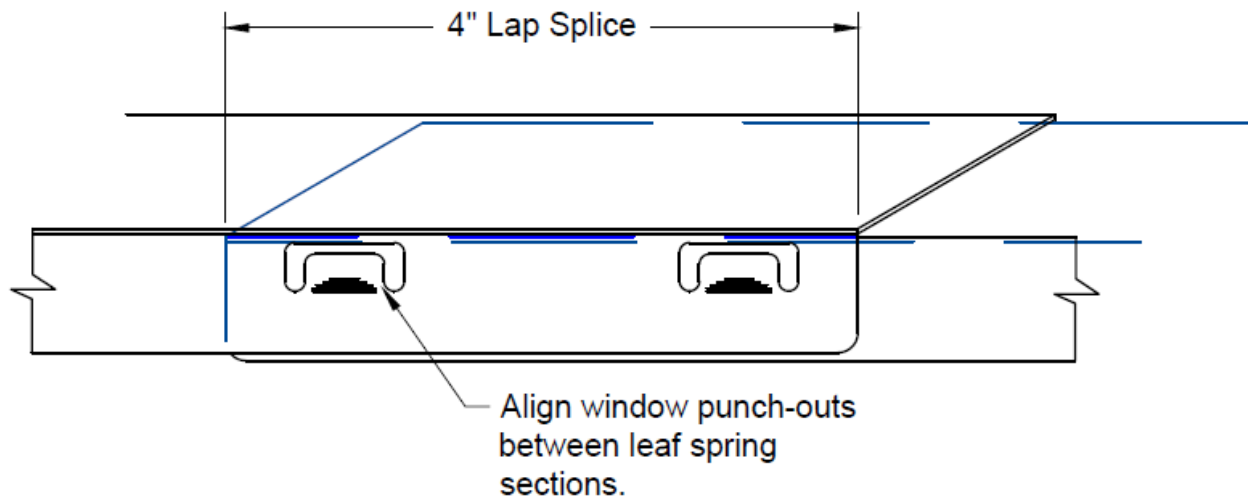

9

Install non-shrink grout into blockout on Leaf Spring side after Leaf Spring and anchors have been installed.

Note: Protect surfaces during placement of blockout infill.

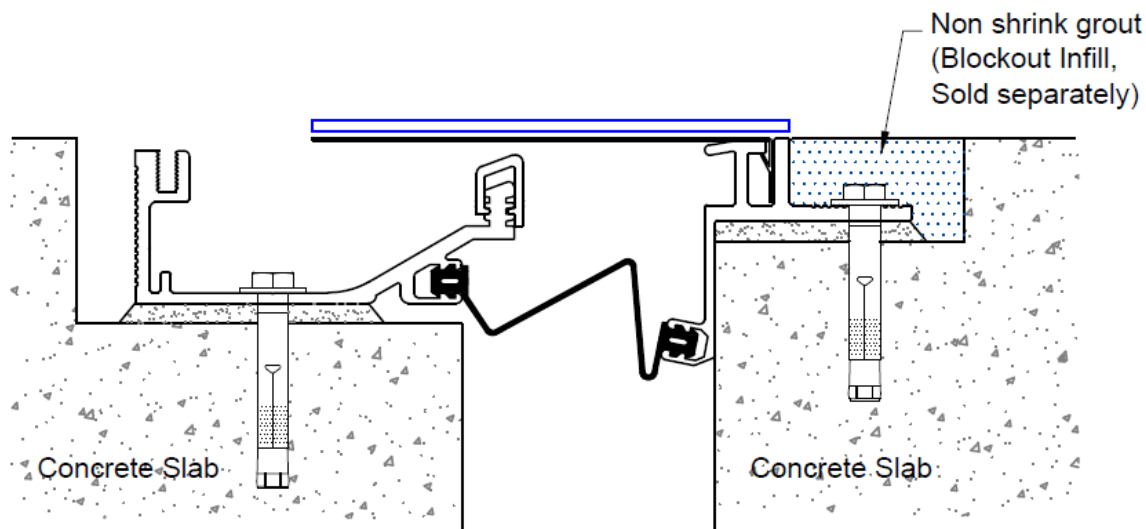
**10**

Install flooring material on Leaf Spring side ONLY.

Note: Follow flooring manufacturer's application procedures for proper installation of flooring material. Prepare Leaf Spring for carpet tape or adhesive as recommended by flooring manufacturer.

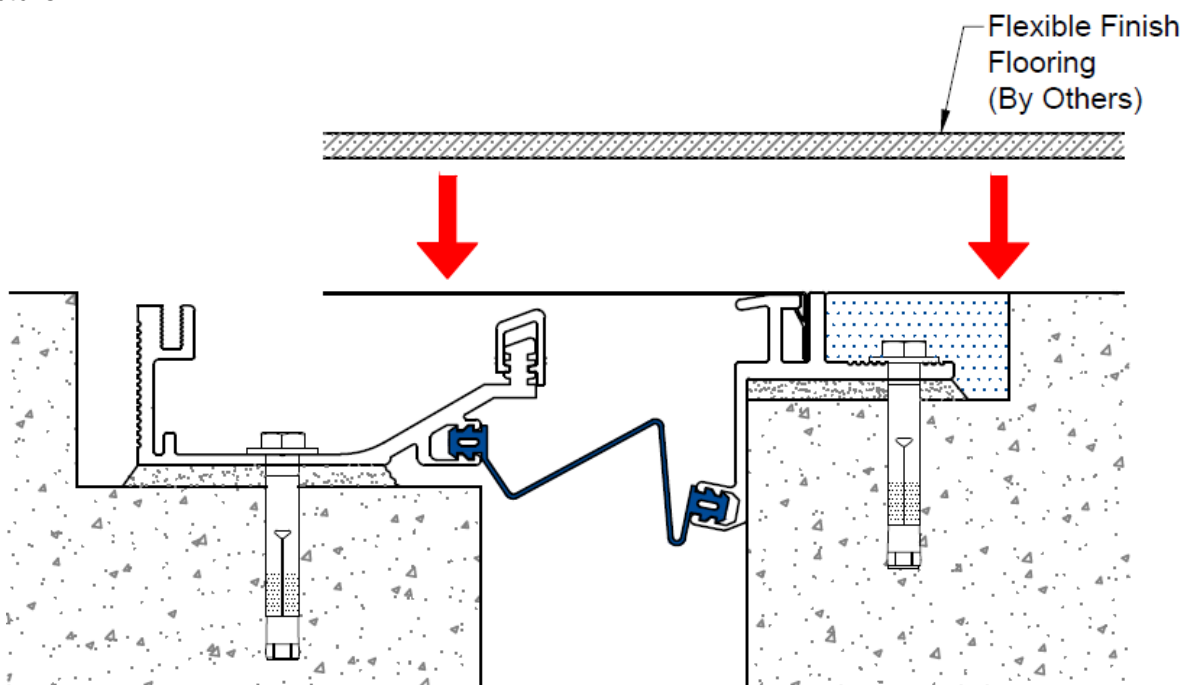

11

Slide trim piece into place, pushing down on the Leaf Spring as shown.

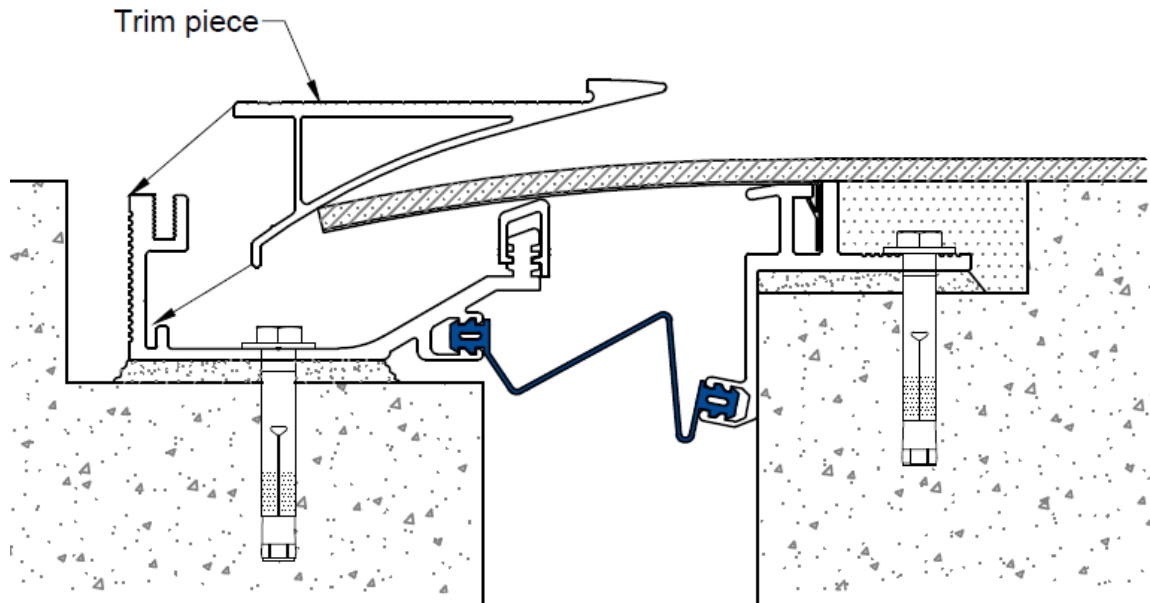

12

Maintain pressure on trim piece. Fasten trim piece to base extrusion utilizing 1/4" diameter CSK machine screw until flush with surface.

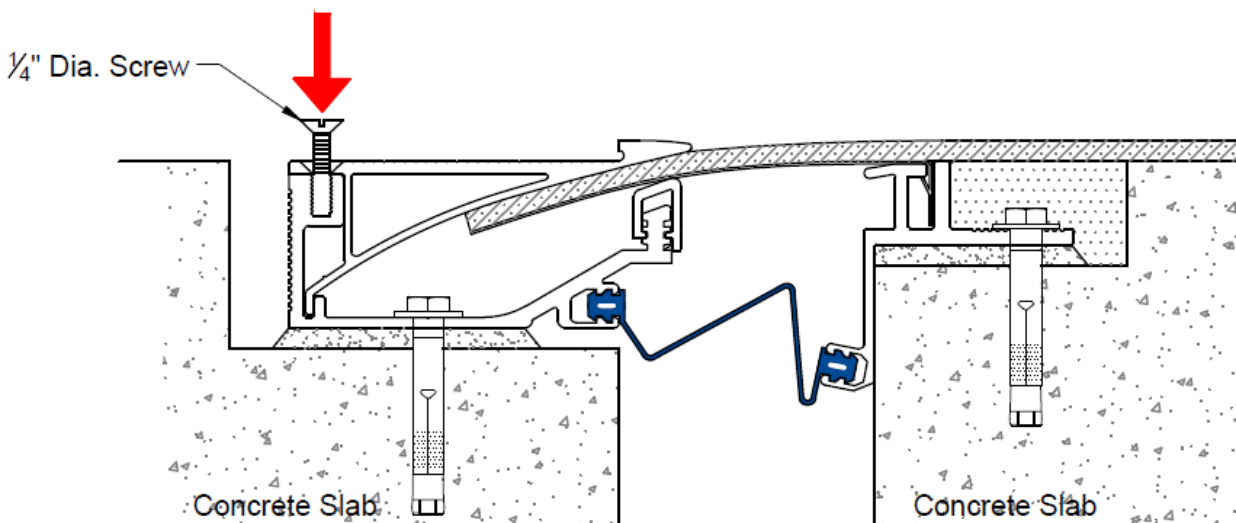

13

Install non-shrink grout into blockout on the base support side.
Note: Protect surfaces during placement of blockout infill.

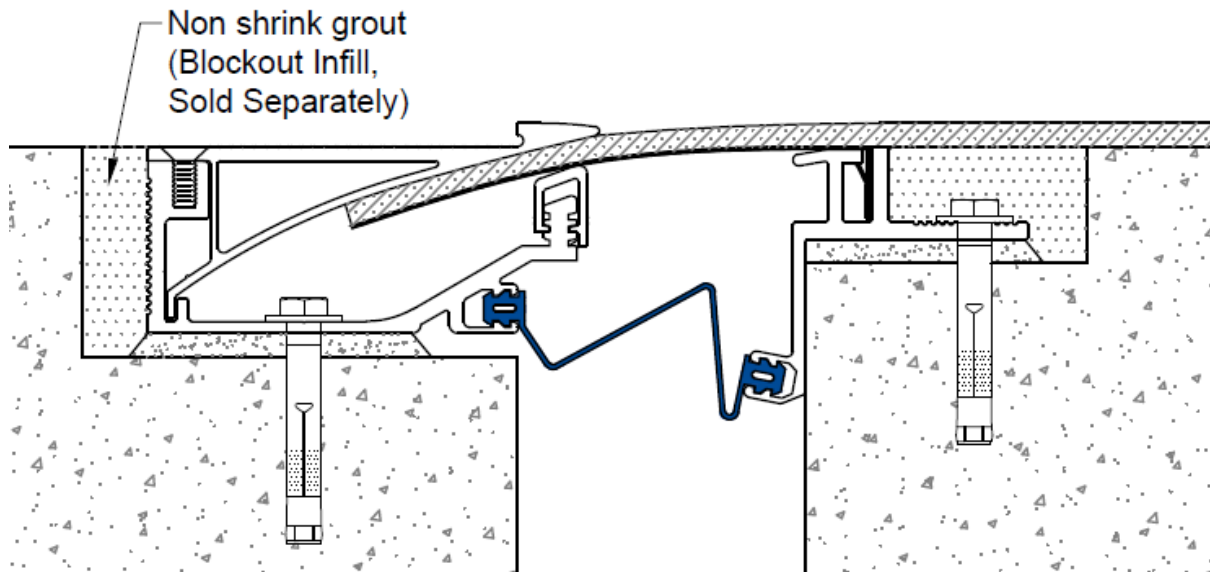
**14**

Finish installing flooring material on trim piece, following flooring manufacturer's application procedures for proper installation of flooring material.

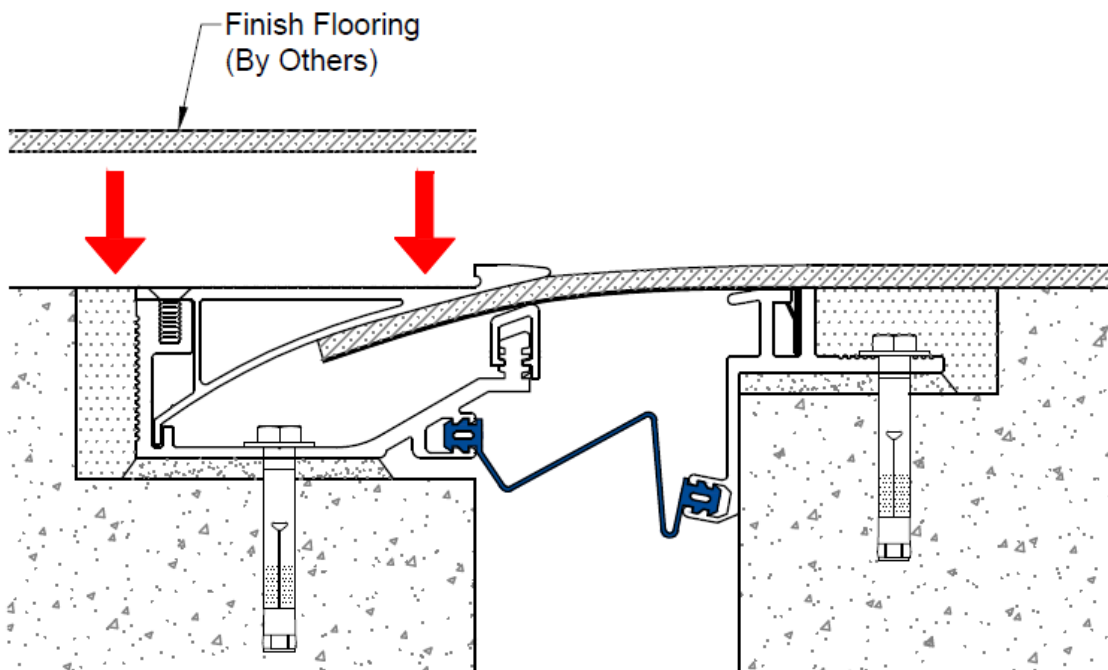

Follow us on social media for industry news, new product announcements & more:

