



ClarkDietrich.

SOLVING CONSTRUCTION PROBLEMS. FROM FRAME TO FINISH.

When it comes to meeting wall and ceiling challenges, and delivering peace of mind, ClarkDietrich leads by example. Today, we're staying at the forefront by refocusing our resources to bring smarter solutions and to better serve our customers.

Vinyl Corp., a brand long associated with our company, will now officially bear our name. All of the same trusted products will be available through ClarkDietrich—which offers an ever-expanding lineup of interior and exterior finishing products.

Of course, ClarkDietrich also stands for the broadest portfolio in cold-formed steel framing, plus nationwide technical support and engineering services.

From the highest-quality standard items, to unmatched specialty products, to completely customized offerings, we'll see to it that your projects will succeed with durability and precision.

Combination Casing Bead & Backer Rod

To properly assemble a wall cladding system using stucco or manufactured stone veneer, the best practice is to maintain a "gap" around door and window openings and install a backer rod with compatible sealant in order to keep moisture out.

The use of BackerBead ensures that the correct caulk gap will be created around all door and window openings on exterior walls. The gap is predetermined by the factory-applied, closed-cell backer rod that is properly aligned and adhered to the vinyl casing bead. This approach eliminates the need to install the backer rod separately, saving time and ensuring a consistent gap width and depth of $\frac{1}{4}$ " x $\frac{1}{4}$ ". When installed and caulked properly, BackerBead provides added protection from water penetration.

Features/Benefits

- **Combination Bead**—Reduces steps in the field installation of casing bead and a separate backer rod. Ensures the backer rod is installed around all door and window openings.
- **Improved Quality**—Factory-applied blue backer rod with preset width and depth to ensure the proper caulk gap for sealant application. When the gap is properly caulked, the blue backer rod will no longer be visible.
- **Separation of Dissimilar Materials**—Properly terminates stucco and mortar at window and door frames; ASTM C1063
- **Sealant Compatibility**—Closed-cell backer rod is compatible with elastomeric and other cold-applied sealants

Physical Properties

- **Vinyl Accessory**—Complies with ASTM D1784, ASTM C1861 and ASTM C1063, Table 1, PVC for exterior use
- **Backer Rod**—Closed-cell material per ASTM C1330 and ASTM C1016, square, flexible, continuous lengths of extruded polyethylene foam used as backing material
- BackerBead components are chemically inert and virtually dust-free

Product Notes

- BackerBead casing bead products with 1" and larger ground height includes an intermediate stiffening rib in the ground flange
- The factory applied $\frac{3}{8}$ " x $\frac{3}{8}$ " backer rod is adhered with set back of $\frac{1}{4}$ " from the leading edge of the ground on BackerBead casing bead products, unless noted
- BackerBead is also available with a solid flange upon request.
Add U to the product code, example: 6650BBU
- Integral backer rod also available in white upon request for clear sealant applications.
Add -WH to product code, example 6650BB-WH

Testing

- In side by side tests, the BackerBead system with sealant passed the E-331 water-penetration test, simulating air pressure of a 50mph wind/rain. Conversely, the stucco system terminated with no isolated jointing failed in less than 15 minutes. Results available upon request.

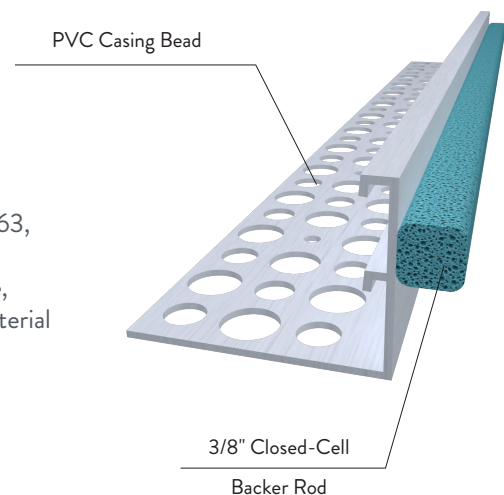

Original BackerBead

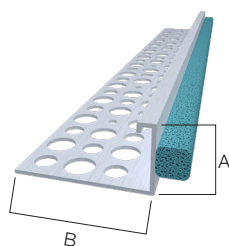
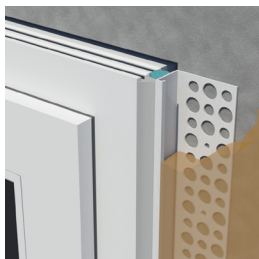

Product Code	(A) Ground	(B) Flange	Length	Pieces per Box
6650BB	1/2"	1-3/4"	10'	50
6658BB	5/8"	1-3/4"	10'	50
6675BB	3/4"	1-3/4"	10'	50
6678BB	7/8"	1-3/4"	10'	50
66100TBB	1"	1-3/4"	10'	50
66125BB	1-1/4"	1-3/4"	10'	50
66150BB	1-1/2"	1-3/4"	10'	40
66175BB	1-3/4"	1-3/4"	10'	40
66200BB	2"	1-3/4"	10'	40

U.S. Patent Numbers D761,971

Original BackerBead

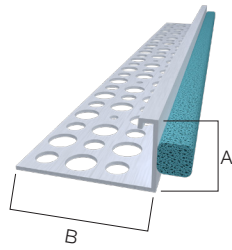
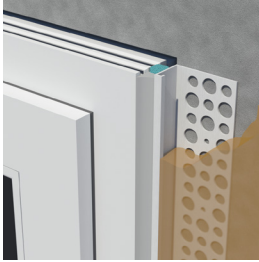

Product Code	(A) Ground	(B) Flange	Length	Pieces per Box
6650BB	1/2"	1-3/4"	10'	50
6658BB	5/8"	1-3/4"	10'	50
6675BB	3/4"	1-3/4"	10'	50
6678BB	7/8"	1-3/4"	10'	50
66100TBB	1"	1-3/4"	10'	50
66125BB	1-1/4"	1-3/4"	10'	50
66150BB	1-1/2"	1-3/4"	10'	40
66175BB	1-3/4"	1-3/4"	10'	40
66200BB	2"	1-3/4"	10'	40

U.S. Patent Numbers D761,971

BackerBead with E-Flange™

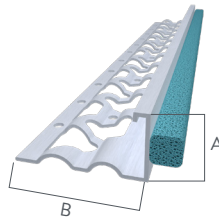
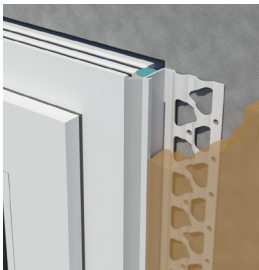

The E-Flange profile provides 80% more stucco embedment than traditional flat flange profiles.

Product Code	(A) Ground	(B) Flange Width	Length	Pieces per Box
6658EFBB	5/8"	1-3/4"	10'	50
6675EFBB	3/4"	1-3/4"	10'	50
6678EFBB	7/8"	1-3/4"	10'	50
66100TEFBB	1"	1-3/4"	10'	50
66125EFBB	1-1/4"	1-3/4"	10'	50
66150EFBB	1-1/2"	1-3/4"	10'	40
66175EFBB	1-3/4"	1-3/4"	10'	40
66200EFBB	2"	1-3/4"	10'	40

U.S. Patent Numbers D842,496 and D843,015

BackerBead with Rip-Bead®

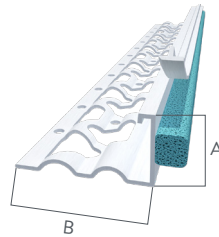
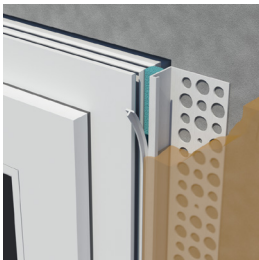

1/4" removable leg provides a clean, stucco-free caulk gap. A clean 1/4" x 1/4" caulk gap assures the most efficient caulk seal for optimal moisture protection.

Product Code	(A) Ground	(B) Flange	Length	Pieces per Box
6658BBR	5/8"	1-3/4"	10'	50
6678BBR	7/8"	1-3/4"	10'	50

U.S. Patent Numbers D762,310

BackerBead with Short Flange

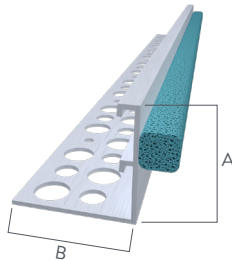

The 1" short flange is perfect for applications where the standard 1-3/4" flange size is too large. Easy to install in tight areas such as recessed doors and windows, providing added moisture protection and a clean finish.

Product Code	(A) Ground	(B) Flange	Length	Pieces per Box
6658BBSF	5/8"	1"	10'	50
6678BBSF	7/8"	1"	10'	50
66125BBSF	1-1/4"	1"	10'	50

U.S. Patent Numbers D761,971

BM 66 Series 1-Piece Bandmaker™

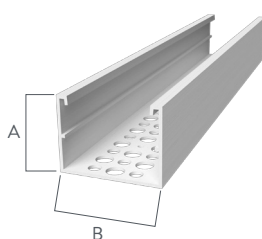

Provides a one-piece band, saving labor time. Additional band widths available.

Product Code	(A) Ground	(B) Band Width	Length	Pieces per Box
BM66100-200	1"	2"	10'	16
BM66150-200	1-1/2"	2"	10'	16
BM66200-200	2"	2"	10'	12
BM66150-250	1-1/2"	2-1/2"	10'	12
BM66200-250	2"	2-1/2"	10'	12
BM66150-300	1-1/2"	3"	10'	12
BM66200-300	2"	3"	10'	12