

A GUIDE FOR INSTALLING WEATHERSMART® COMMERCIAL

Fortifiber Building Systems Group® provides this guide to assist builders by demonstrating an efficient and effective method for installing Fortifiber's WeatherSmart Commercial weather-resistive barrier in commercial applications.

Compliance with the local building code and proper installation are critical in reducing potential water intrusion. It is the responsibility of the architect or builder to ensure that these standards are met.

WeatherSmart Commercial is available in two convenient sizes to meet your needs: 10' x 125' lineal feet and 5' x 200' lineal feet. The following Fortifiber Building Systems Group products are needed for a quality installation:

- **Fortifiber Commercial Tape**
3" x 165' rolls
- **Moistop® Sealant**
- **Any Fortifiber Window Flashing Product – FortiFlash® Commercial or FortiFlash® Butyl are recommended.**

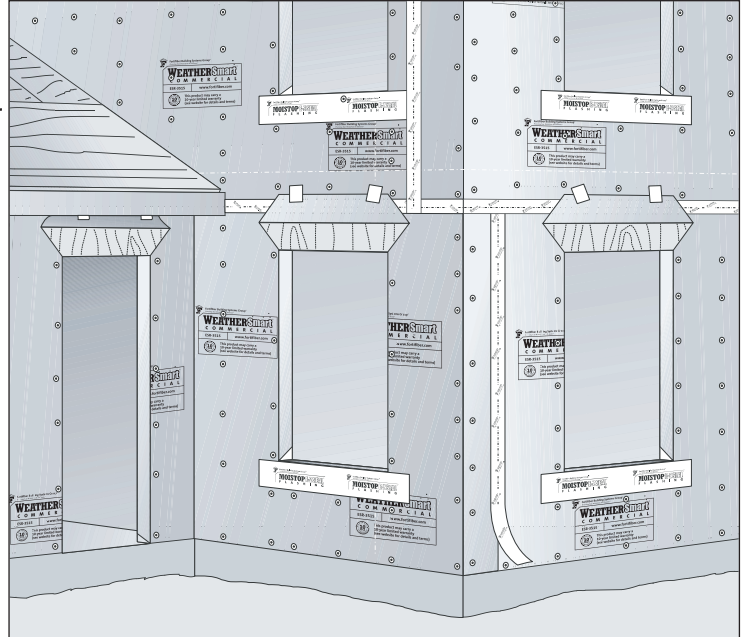

1 INSTALLING WRB

Install weather-resistive barrier over an approved exterior sheathing. Starting at the bottom of one end of the wall, place the weather-resistive barrier roll horizontally and roll out the first course evenly, covering rough window and door openings. When starting at a corner, overlap by a minimum of 12". Attach the membrane so that it is tight and flat. Fasten material securely to the exterior wall with appropriate fasteners (Step 2).

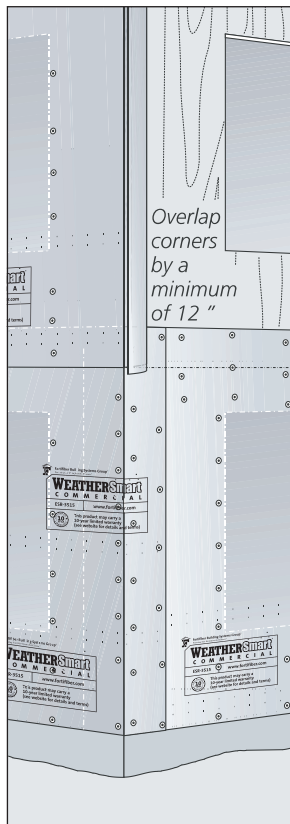

2 FASTENING

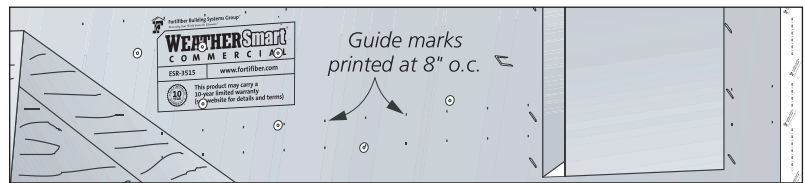

Install corrosion resistant fasteners as needed to attach WeatherSmart Commercial taut and flat until it can be covered by the final exterior cladding. The fastener type and spacing will vary depending on exposure conditions and the substrate. When installing over gypsum based sheathing, the fasteners need to be installed into the studs or backing.

3 OVERLAP AND TAPE SEAM

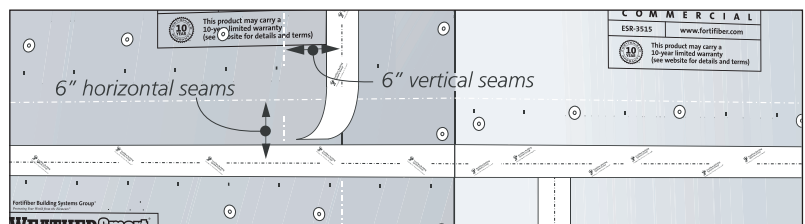

At vertical seams, apply a minimum of 6" vertical overlap. When going around corners, make sure the material is pulled tightly and properly fastened. Any succeeding course should be placed horizontally over the lower course in a weather-board fashion with a minimum horizontal overlap of 6". It is recommended to tape all vertical seams with Fortifiber Commercial Tape; all seams must be taped to achieve an air barrier install; consult your design professional where necessary.

4

REPAIRING RIPS AND TEARS

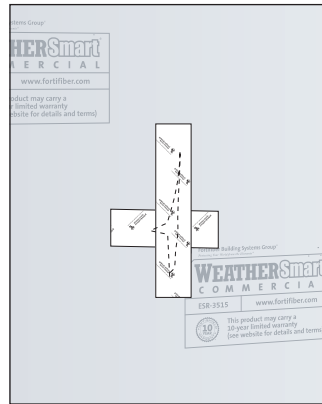
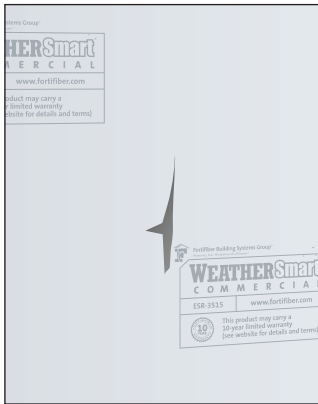

Small tears may be repaired using **Fortifiber Commercial Tape** or **FortiFlash®**, **FortiFlash Commercial** or **FortiFlash Butyl** flashing.

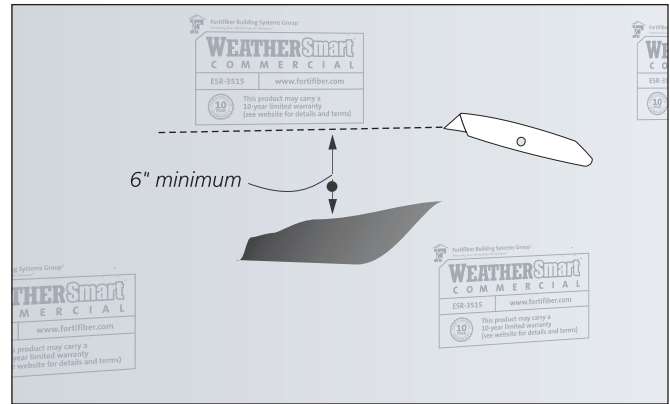

Larger tears can be repaired by cutting a patch of **WeatherSmart Commercial** at least 12" wider and 18" taller than the tear to be patched. First, cut a slit in the weather-resistant barrier 6" above the tear, wide enough to accommodate the patch.

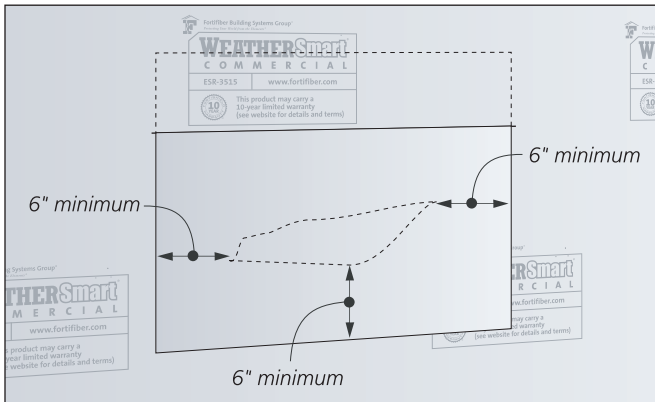

Slip the patch into the slot extending it 6" behind the weather-resistant barrier.

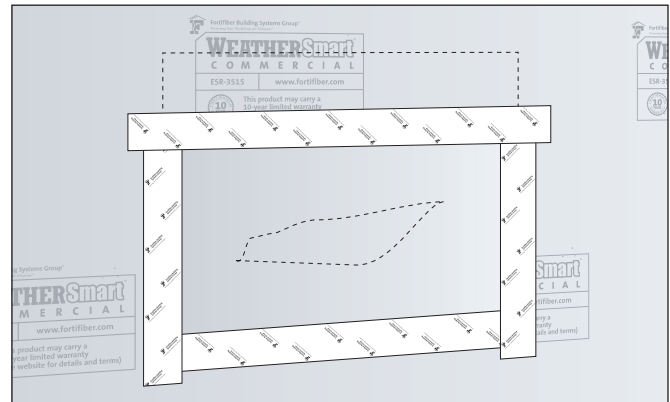

Tape the patch to the weather-resistant barrier in weatherboard fashion, starting at the bottom, then sides, then top using **Fortifiber Commercial Tape**. The tape on the sides should extend beyond the bottom piece a minimum of 1", and the tape at the top should extend beyond the side tape pieces by a minimum of 1".

5 USE WITH STUCCO

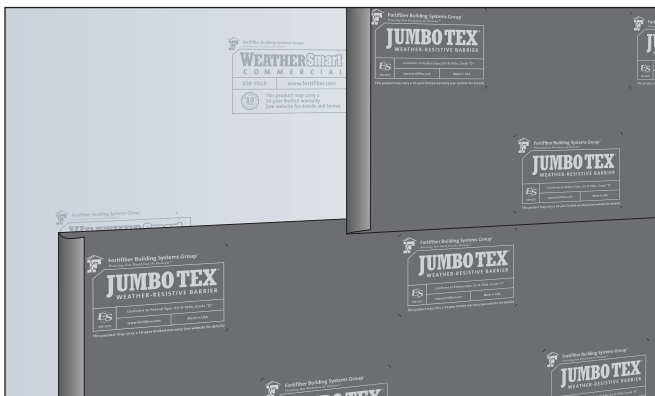

When stucco cladding is to be used, the **WeatherSmart Commercial** should be covered with a layer of **Jumbo Tex®** or **60 Minute Super Jumbo Tex® Grade D** asphalt-saturated building paper.

Limitations: Product should be covered within 12 months. To ensure maximum exposure time, store unused product in an area not exposed to sunlight. Inspect product to insure it is free of any protrusions or damage which may detract from the weather-resistant barrier integrity. Holes, tears or punctures should be sealed with **Moistop® Sealant** or **Fortifiber Commercial Tape**. This product is not recommended for horizontal, roofing or below grade applications. Ensure that a layer of **Super Jumbo Tex 60** minute is used to separate **WeatherSmart Commercial** and Portland cement stucco or mortar used in masonry veneer walls.



Protecting Your World from the Elements®

NATIONAL SALES OFFICE - Fernley, NV

(9/8/15)

Call 1-800-773-4777 Nationwide for Technical Assistance or visit our Web site at www.fortifiber.com