

# PRODUCT DATA

MasterFormat: 07 13 26

W. R. MEADOWS®

SEALTIGHT®

NO. 714

OCTOBER 2013  
(Supersedes July 2012)

## MEL-ROL®

### Rolled, Self-Adhering Waterproofing Membrane

#### DESCRIPTION

MEL-ROL waterproofing system is a flexible, versatile, dependable, bituminous, roll-type waterproofing membrane. It is composed of a nominally 56 mil thick layer of polymeric waterproofing membrane on a heavy duty, four-mil thick, cross-laminated polyethylene carrier film. The two components are laminated together under strict quality-controlled production procedures.

A handy overlap guideline is printed 2 ½" (63.5 mm) in from the material edge on each side to assure proper overlap coverage and to assist in maintaining a straight application. Special exposed polymeric membrane strips are provided on both sides for positive membrane-to-membrane adhesion in the overlap area. The membrane strips are protected by a pull-off release strip. All components of the MEL-ROL waterproofing system work together to provide a cost-effective, positive waterproofing system that's quick and easy to apply.

W. R. MEADOWS accessory products included in the MEL-ROL waterproofing system are: BEM, MEL-ROL LIQUID MEMBRANE, MEL-PRIME™ adhesive (solvent-based and water-based), POINTING MASTIC, DETAIL STRIP, CATALYTIC BONDING ASPHALT, TERMINATION BAR, PROTECTION COURSE and MEL-DRAIN™ drainage board.

#### USES

MEL-ROL waterproofing system provides a cost-effective answer to properly waterproof foundations, vertical walls, and below-grade floors in residential and commercial construction. It is equally effective for use as between-the-slab waterproofing on plaza decks, parking decks, and structural slabs. Use it as a waterproofing membrane to isolate mechanical and electronic rooms, laboratories, kitchens, and bathrooms. MEL-ROL offers positive protection when "wrapped around" major rapid transit, vehicular, utility, and pedestrian tunnel projects. MEL-ROL can also be used on insulated concrete forms (ICF).

Installation of PROTECTION COURSE from W. R. MEADOWS is recommended before backfilling. MEL-ROL can also be used with drainage boards when specified.

#### FEATURES/BENEFITS

- Provides cost-effective, flexible, versatile, dependable, positive waterproofing protection against damaging moisture migration and the infiltration of free water.
- Offers a quick and easy-to-apply system for maximum productivity.
- Special membrane-to-membrane adhesion provides additional overlap security.
- Meets or exceeds the test requirements of all currently applicable specifications.
- Components work together for positive waterproofing protection.
- Handles with ease on the jobsite.
- Available in a low temperature version for use when air and surface temperatures are between 20° F (-7° C) and 60° F (16° C). An extra-low temp version is also available, ideal for application in extra-low temperatures down to 0° F (-18° C).

#### PACKAGING

38.5" (977.9 mm) wide x 62.5' (19.1 m) long, one roll per carton.

#### COVERAGE

Provides 200 ft.<sup>2</sup> (18.6 m<sup>2</sup>) per roll. Gross coverage is 200 ft.<sup>2</sup> (18.6 m<sup>2</sup>). [Net coverage is 187.5 ft.<sup>2</sup> (17.4 m<sup>2</sup>) with overlap of 2 ½" (63.5 mm).]

#### STORAGE AND HANDLING

Store membrane cartons on pallets and cover if left outside. Keep materials away from sparks and flames. Store where temperature will not exceed 90° F (32° C) for extended periods of time.

#### SPECIFICATIONS

- A.R.E.M.A.® Specifications Chapter 29, Waterproofing
- LARR Report 26022

#### APPLICATION

**Surface Preparation ...** Concrete should be cured at least 72 hours, be clean, dry, smooth, and free of voids. Repair spalled areas; fill all voids and remove all sharp protrusions.

*CONTINUED ON REVERSE SIDE...*

#### W. R. MEADOWS, INC.

P.O. Box 338 • HAMPSHIRE, IL 60140-0338  
Phone: 847/214-2100 • Fax: 847/683-4544  
1-800-342-5976  
[www.wrmeadows.com](http://www.wrmeadows.com)

HAMPSHIRE, IL / CARTERSVILLE, GA / YORK, PA  
FORT WORTH, TX / BENICIA, CA / POMONA, CA  
GOODYEAR, AZ / MILTON, ON / SHERWOOD PARK, AB

## MEL-ROL COMBINES POSITIVE WATERPROOFING PROTECTION WITH EASE OF HANDLING

### EXCLUSIVE FEATURES

A handy overlap guideline is printed 2 ½" (63.5 mm) in from the material edge on each side, assuring proper overlap coverage and assisting in maintaining a straight application. The polymeric waterproofing membrane is protected by a special, easy-to-remove release paper. The exposed membrane strips on the material edges are protected by a pull-off release strip. Exposed polymeric membrane strips are provided on both sides of MEL-ROL for positive membrane-to-membrane adhesion in the overlap area ... note the detail, as shown in inset photo.

TECHNICAL DATA		
PROPERTY	TYPICAL VALUE	TEST METHOD
COLOR ... Carrier Film	White	
Polymeric Membrane	Black	
THICKNESS ... Carrier Film	4 mils	
Polymeric Membrane	56 mils	
TENSILE STRENGTH ... Carrier Film	5900 psi min. (40.71 MPa)	ASTM D 412
Membrane	460 psi (3230 KPa)	(Die C)
ELONGATION	971.3%	ASTM D 412
LOW TEMP CRACK BRIDGING		
100 Cycle -25° F (-32° C)	Pass	ASTM C 836
PEEL ADHESION	11.8 lb./in. (2068 N/m)	ASTM D 903
LAP ADHESION	8.62 lbf/in. (1508.5 N/m)	ASTM D 1876
WATER VAPOR PERMEABILITY	0.036 Perms	ASTM E-96, B
WATER ABSORPTION	0.1%, 72 hrs. max.	ASTM D570
HYDROSTATIC RESISTANCE	Equiv. to 230.9' (70.38 m) of water	ASTM D 5385
PUNCTURE RESISTANCE	50 lbf (222 N)	ASTM E154
EXPOSURE TO FUNGI	Pass, 16 weeks	Soil Test
FLEXIBILITY @ -20° F (-29° C)	Pass	ASTM D 1970

### MEL-ROL IS QUICK AND EASY TO APPLY

**Temperature ...** Apply in dry, fair weather when the air and surface temperatures are above 40° F (4° C). Do not apply to frozen concrete.

MEL-ROL LOW TEMP can be used when air and surface temperatures are between 20° F (-7° C) and 60° F (16° C).

**Surface Conditioning ...** Apply MEL-PRIME adhesive to surfaces that will be covered within one working day. If left exposed overnight, additional adhesive must be applied. Follow all instructions and precautions on containers.

REMOVE release paper from MEL-ROL from the top edge of the roll and firmly press exposed area to the wall. Remove the release paper from the rolls in a downward direction, pressing MEL-ROL into place on the wall.

**Footing Details ...** Use DETAIL STRIP for impaction sheet coverage. First, fold strips lengthwise and then cut at the fold. Material is then ready to install as 4 ½" (114.3 mm) strips on either side of the rebar. Any excess can be turned down on the face of the footing. Next, fill the voids around rebars in the keyway with CATALYTIC BONDING ASPHALT. Pour the walls. Install DETAIL STRIP horizontally along the wall where it meets the footing, placing half the material up the wall and the other half onto the footing. Extend the material 4 ½" (114.3 mm) beyond outside corners. Slit extended portion of DETAIL STRIP lengthwise. Place the horizontal flap out onto the footing and bend the vertical flap around the wall. (See Diagram A.) Repeat this procedure in the opposite direction as shown in Diagram B.

MEL-ROL can be applied to concrete, masonry surfaces, wood, insulated wall systems, and metal. All substrates must be clean, dry, and free of all surface irregularities.

**DIAGRAM A**  
Outside Corner

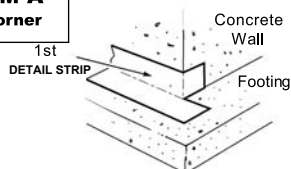

**DIAGRAM B**  
Outside Corner

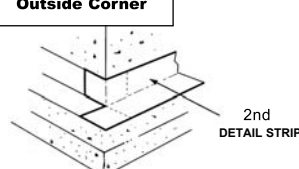

**Horizontal Application ...** Remove release paper on edge, then position the MEL-ROL membrane. Pull balance of release paper off, running the roll from low to high points, so all laps will shed water. Stagger end laps and overlap all seams at least 2 ½" (63.5 mm). Apply a double-thickness of the MEL-ROL membrane over construction, control, all expansion joints and over cracks greater than 1/16" (1.59 mm) wide.