



ClarkDietrich.

SOLVING CONSTRUCTION PROBLEMS. FROM FRAME TO FINISH.

When it comes to meeting wall and ceiling challenges, and delivering peace of mind, ClarkDietrich leads by example. Today, we're staying at the forefront by refocusing our resources to bring smarter solutions and to better serve our customers.

Vinyl Corp., a brand long associated with our company, will now officially bear our name. All of the same trusted products will be available through ClarkDietrich—which offers an ever-expanding lineup of interior and exterior finishing products.

Of course, ClarkDietrich also stands for the broadest portfolio in cold-formed steel framing, plus nationwide technical support and engineering services.

From the highest-quality standard items, to unmatched specialty products, to completely customized offerings, we'll see to it that your projects will succeed with durability and precision.

Casing Beads

Archmaker™ Casing Bead

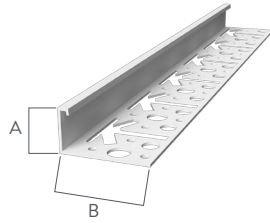

Designed to easily conform to most arched and curved designs. Works for curved bands on walls as well.

Product Code	(A) Ground	(B) Flange	Length	Pieces per Box
6625A	1/4"	1-3/4"	10'	100
6638A	3/8"	1-3/4"	10'	100
6650A	1/2"	1-3/4"	10'	100
6658A	5/8"	1-3/4"	10'	100
6675A	3/4"	1-3/4"	10'	75
6678A	7/8"	1-3/4"	10'	75
66100A	1"	1-3/4"	10'	75

Note: If weep holes are required, add W to the product code, example: 6625AW.

Archmaker™/Bandmaker™ Casing Bead

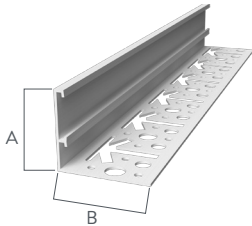

Designed to easily conform to most arched and curved designs with a reinforcing rib to assist in keying heavy material fills. Ideal when bands are used in architectural designs.

Product Code	(A) Ground	(B) Flange	Length	Pieces per Box
66125A	1-1/4"	1-3/4"	10'	50
66150A	1-1/2"	1-3/4"	10'	50
66175A	1-3/4"	1-3/4"	10'	40
66200A	2"	1-3/4"	10'	40

Large Flange Casing Bead

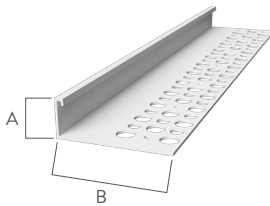
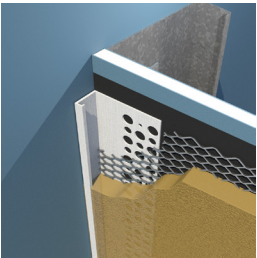

Terminates stucco and plaster against doors, windows, and other dissimilar materials.

Product Code	(A) Ground	(B) Flange	Length	Pieces per Box
6638L	3/8"	2-1/2"	10'	75
6650L	1/2"	2-1/2"	10'	75
6658L	5/8"	2-1/2"	10'	75
6675L	3/4"	2-1/2"	10'	50
6678L	7/8"	2-1/2"	10'	50
66100L	1"	2-1/2"	10'	50
6650XL	1/2"	5"	10'	40
6658XL	5/8"	5"	10'	40
6675XL	3/4"	5"	10'	40
6678XL	7/8"	5"	10'	40
66100XL	1"	5"	10'	25
66125XL	1-1/4"	5"	10'	25
66150XL	1-1/2"	5"	10'	20
66175XL	1-3/4"	5"	10'	20
66200XL	2"	5"	10'	20

Note: If weep holes are required, add W to the product code, example 6638LW.

Angle Casing Beads

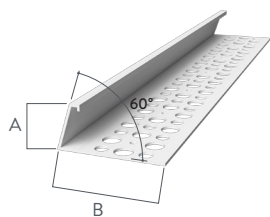

Terminate stucco and plaster against windows, doors and other dissimilar materials. Provides a tapered transition, to direct moisture away from the wall. Do not cover exterior angle of bead with stucco or plaster.

Product Code	(A) Ground	(B) Flange	Length	Pieces per Box
6658-60	5/8"	2"	10'	50
6675-60	3/4"	2"	10'	50
6678-60	7/8"	2"	10'	50
66100-60	1"	2"	10'	50
66125-60	1-1/4"	2"	10'	50
66150-60	1-1/2"	2"	10'	50
66200-60	2"	2"	10'	40