

REBAR & SCAFFOLDING ACCESSORIES

Spyra-Lox® Rebar Lap-Joint Tie ●

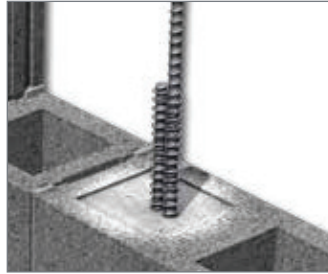

Spyra-Lox®

SL 4/5 - #4 or #5 rebars.
SL 6/7 - #6 or #7 rebars.
SL 8/9 - #8 or #9 rebars (#9 is 1-1/8" o.d. nominal, 1.27" actual).
SL 11 - #11 rebars (1-1/4" o.d. nominal, 1.41" actual).

No tools. Eliminates cumbersome procedure of tying lap-joined rebars together in reinforced walls. Increases worker productivity. Reduces lifting-height of block over rebars. Flow-through design allows grout to uniformly encase rebars at overlap.

Finish: Mill Galvanized

Wire manufactured from a minimum of recycled material. **95%**

RB & RB-Twin ● Rebar Positioners

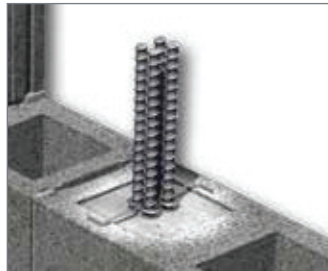

RB - 9 ga. dia. wire for 6", 8", 10" or 12" block.

For positioning rebars in center of block. The z-shaped wire bridges cell of block while bends rest on shell.

RB-Twin - Same as above with double loops to hold 4 rebars.

Finishes: Mill Galvanized
Hot Dipped Galvanized
Stainless Steel (Type 304 or 316)

OSHA and Mushroom Caps



OSHA Caps - 4X4 high-impact plastic and durable texture provides extensive protection on construction work zones. This product meets Federal OSHA Standards.

Standard: Size 3-7
Medium: Size 8-12
Large: Size 12 & Up

Mushroom Caps - Used as a protective cover for bolts, pipes, rebar and other protrusions that could be potentially hazardous. This product is not intended to eliminate impalement or accidental falls, but to reduce possible risks or dangers.

Standard: Fits a variety of diameters from 1/2" to 2-1/4".

SCAFFOLD CLIPS

Scaffold Clips are used to secure poly or safety fence to scaffolding easily and quickly. Manufactured from a flexible plastic that will not become rigid or snap in extreme conditions.

Available - 6" or 11" long, 100 pieces per box.

