

Installation Procedure

Last Updated: February 2019



Wabo®RoofCover, Model RFC-C

Roof Expansion Joint System

The following installation procedure is very important and must be fully understood prior to beginning any work. To ensure proper installation and performance of expansion joint system the following actions must be completed by the installing contractor. Failure to do so will affect product warranty.

- 1) Carefully read and understand installation procedure. Contact WBA's Technical Service Department at (800) 677-4922 for product assistance.
- 2) Inspect all shipments and materials for missing or damaged components and hardware. Contact Customer Service at (800) 677-4922 with WBA's order number and invoice for prompt assistance.
- 3) Inspect substrate or adjacent construction for acceptance before beginning work. Report unacceptable construction to the project manager for scheduled repair work.
- 4) Review WBA shop drawings for project specific detailed information if Engineering services were purchased at time of order.

Information provided herein, including but not limited to, any drawing, design, photograph, graphic, or statement(s) ("Materials") are proprietary and the property of Watson Bowman Acme Corp. ("Company"). Reproduction, translation, or reduction to any electronic medium or machine readable form, in whole or part, is strictly prohibited, except for the express purpose for which it has been furnished, without prior written consent of Company. All Materials contained herein are provided by Company for information purposes only. Company reserves the right to amend or withdraw any information contained in the Materials without notice. All technical or other advice by Company, whether verbal or written, concerning products, or the use of products in specific situations ("Advice") is given by Company and is used at the User's own risk.

Health & Safety

During the installation of any Watson Bowman Acme product, appropriate personal protective items should be worn at all times, including but not limited to the following:

- Proper work clothing
- Safety glasses
- Safety boots
- Gloves
- Hard hat



Local rules and regulations regarding safe work environments and health should be followed.

Product Components

The following are standard components required for the installation of this product:

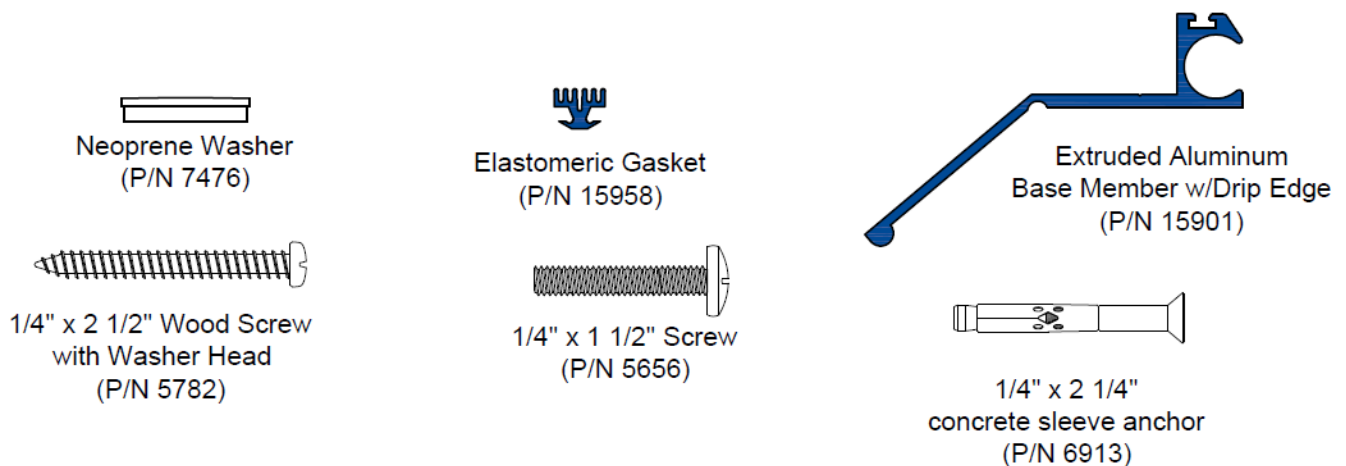

Components shown below vary in size depending on model of system:

Installers note: Shown below are components that are shipped in varying sizes according to joint system model to be installed. Consult your shipping documents for proper part listings and requirements.

Note: shipment should include splicing hardware and components which are not shown on this page

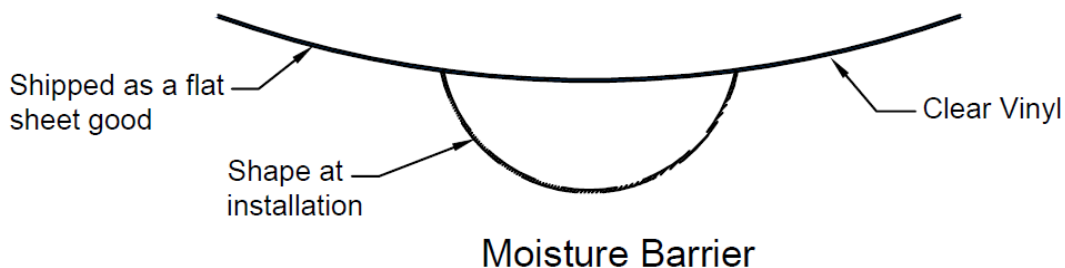

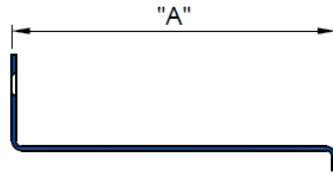

Aluminum Cover Plate

Model	"A"	Part Number	Model	"A"	Part Number
RFC-200C	3 3/4"	15910	RFC-1000C	15 7/8"	15914
RFC-400C	6 3/4"	15911	RFC-1200C	18 7/8"	15915
RFC-600C	9 3/4"	15912	RFC-1800C	27 7/8"	15916
RFC-800C	12 3/4"	15913	RFC-2400C	36 7/8"	15917

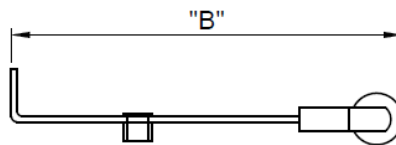

Self-centering bar

Model	"B"	Part Number
RFC-1000C	14"	15660
RFC-1200C	16"	15661
RFC-1800C	22"	15663
RFC-2400C	28"	15665



Splice plate

Note: splice plate has same configuration as cover plate but is 2" lg.

Model	Part Number	Model	Part Number
RFC-200C	15931	RFC-1000C	15935
RFC-400C	15932	RFC-1200C	15936
RFC-600C	15933	RFC-1800C	15937
RFC-800C	15934	RFC-2400C	15938

Installation

1

Install moisture barrier. Ensure proper drape and relaxation to accommodate joint movement.

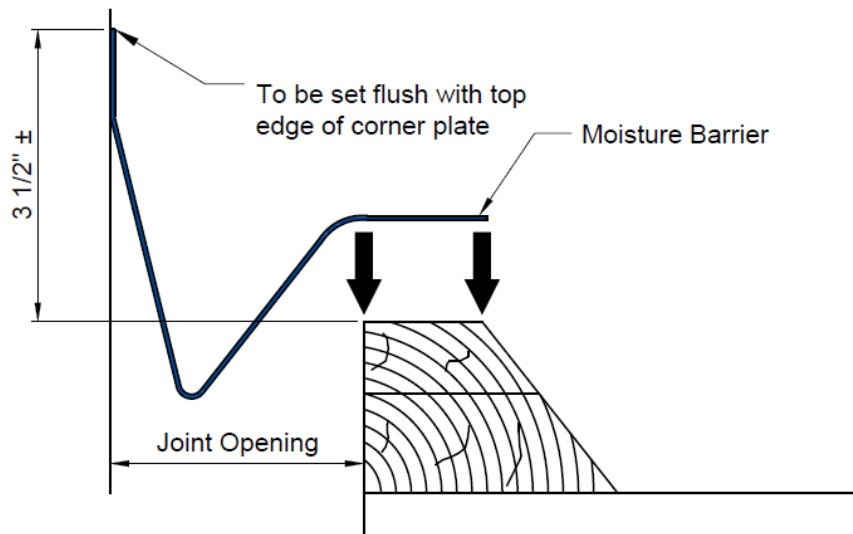
**2**

Position extruded aluminum base member from the inside edge of the wood and fasten base member down utilizing wood screws.

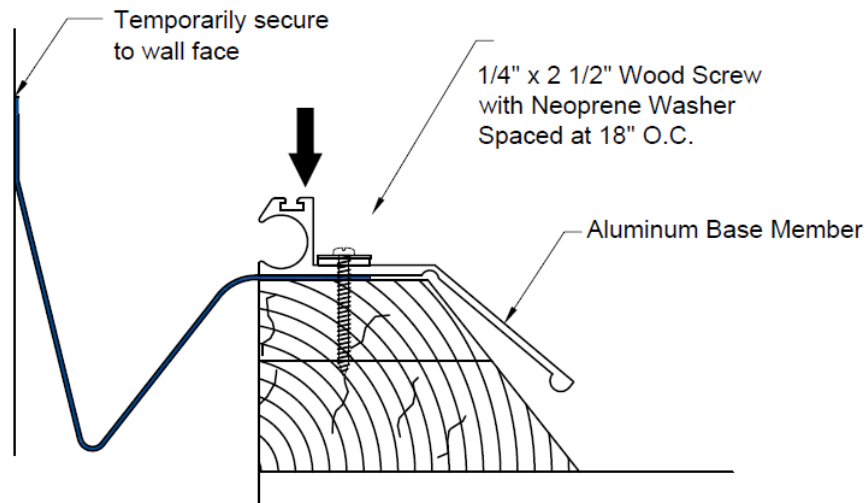

3

If the waterproofing membrane terminates at the cant strip of the expansion joint, the system can be fastened to the cant strip by using the built-in drip edge on the base member. The contractor can drill a small hole in the flange of the base member to allow the exterior deck screw to anchor the flange of the base member as well as the waterproofing membrane to the roof cant strip.

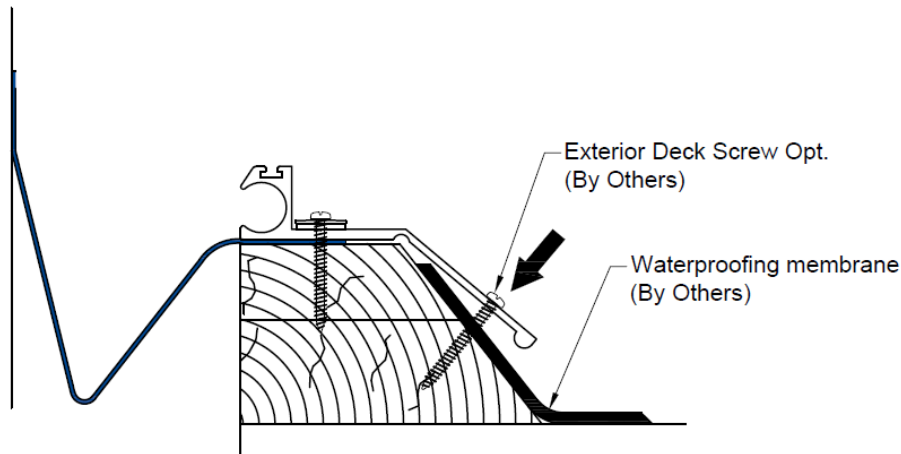
**4**

As work progresses with placement of base members, install self-centering bars by sliding the spherical ends of the bars into and through the circular cavities of the base members. Set at an approximate spacing of 18" O.C. Ensure that the "top" indicator is facing up and that all bars are in the same orientation. Once in place, use small pieces of duct tape to hold it level for easy insertion of screws while attaching aluminum cover.

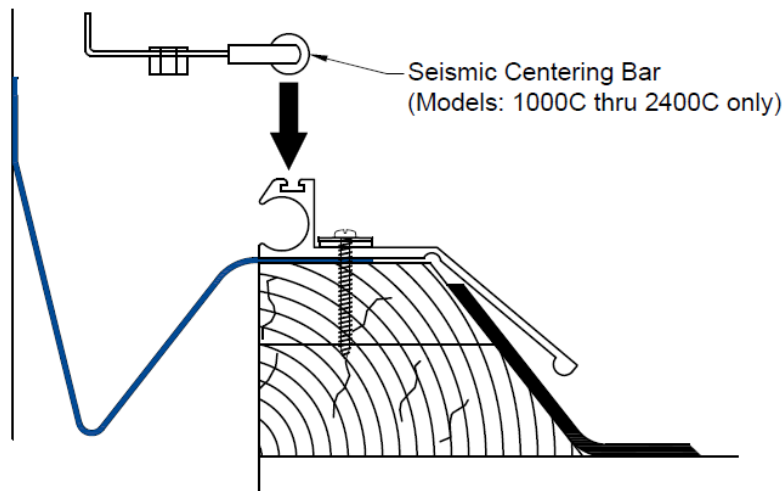

5

Install elastomeric gasket. It is recommended to slide gasket into extrusion cavity from its ends as work progresses.

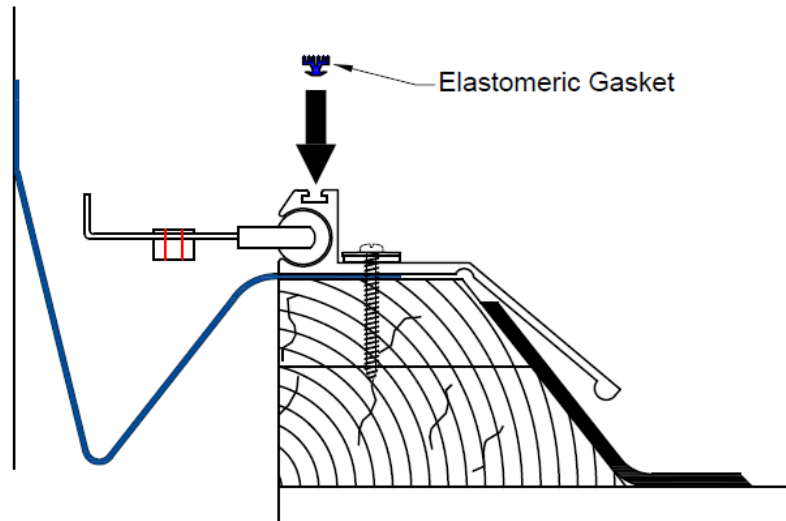

6

Following anchor manufacturer's installation procedure, fasten the aluminum cover plate to the wall by using the 1/4" dia concrete anchor.

Note: For system sizes 1000C thru 2400C, fasten the aluminum cover plate to the centering bars by using the 1/4" dia screw with neoprene washer. Once the cover plate has been fastened to the centering bars the cover plate can be fastened to the wall using the 1/4" dia concrete anchors.

1/4" Dia Concrete Anchor
Spaced at 18" O.C.

1/4" screw with neoprene washer
(RFC-1000C thru 2400C only)

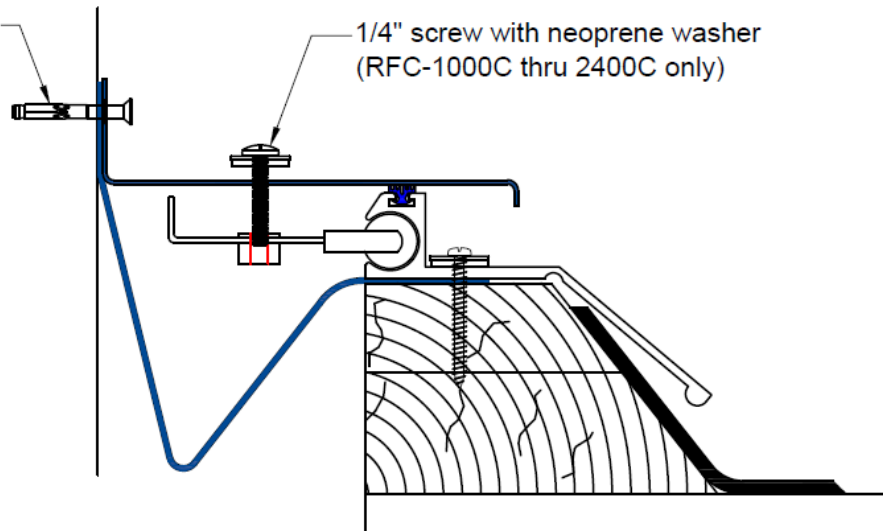

7

