



Installation Procedure

Watson Bowman Acme 95 Pineview Drive Amherst, NY 14228

phone: (716) 691-7566 fax: (716) 691-9239

www.watsonbowmanacme.com

Information provided herein, including but not limited to, any drawing, design, photograph, graphic, or statement(s) ("Materials") are proprietary and the property of Watson Bowman Acme ("Company"). Reproduction, translation, or reduction to any electronic medium or machine readable form, in whole or part, is strictly prohibited, except for the express purpose for which it has been furnished, without prior written consent of Company. All Materials contained herein are provided by Company for information purposes only. Company reserves the right to amend or withdraw any information contained in the Materials without notice. All technical or other advice by Company, whether verbal or written, concerning products, or the use of products in specific situations ("Advice") is given by Company and is used at the Users own risk.



Wabo® WeatherSeam Model(s) "WSW 200-600" Horizontal & Vertical Expansion Control Systems

The following installation procedure is very important and must be fully understood prior to beginning any work. To ensure proper installation and performance of expansion joint system the following actions must be completed by the installing contractor. **Failure to do so will affect product warranty.**

- 1) Carefully read and understand installation procedure. Contact WBA's Technical Service Department at (800) 677-4922 for product assistance.
- 2) Inspect all shipments and materials for missing or damaged components and hardware. Contact Customer Service at (800) 677-4922 with WBA's order number and invoice for prompt assistance.
- 3) Inspect substrate or adjacent construction for acceptance before beginning work. Report unacceptable construction to the project manager for scheduled repair work.
- 4) Review WBA shop drawings for project specific detailed information if Engineering services were purchased at time of order.

Standard Components

Sheet
1
of 4

Watson Bowman Acme
95 Pineview Drive Amherst, NY 14228
phone: (716) 691-7566 fax: (716) 691-9239
www.watsonbowmanacme.com

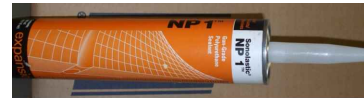
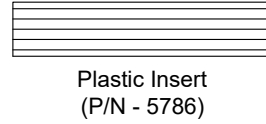
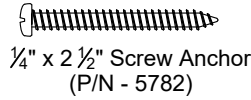
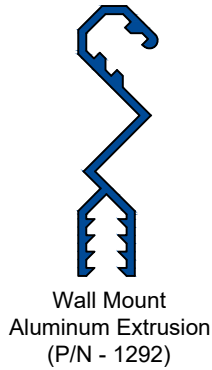

* Optional Components for Splice Procedures. Place order for required Quantities

Components shown below vary in size and profile depending on model of system

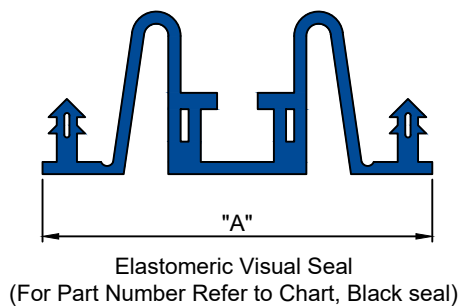

Dimension Chart & Part Number		
Model	"A"	Part Number
WSC-200	2"	1201
WSC-300	3"	1204
WSC-400	4"	1342
WSC-500	5"	1262
WSC-600	6"	1362

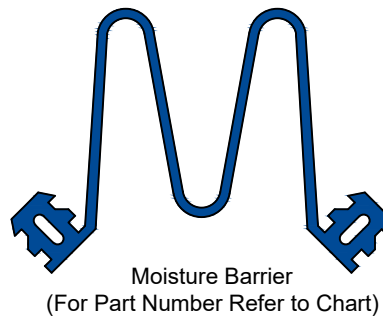

Dimension Chart & Part Number		
Model	"B"	Part Number
WSC-200	1 3/8"	1181
WSC-300	1 3/8"	1181
WSC-400	4 1/8"	1175
WSC-500	4 1/8"	1175
WSC-600	4 1/8"	1175

Installation procedure: "WSC" WeatherSeam system

Information provided herein, including but not limited to, any drawing, design, photograph, graphic, or statement(s) ("Materials") are proprietary and the property of Watson Bowman Acme ("Company"). Reproduction, translation, or reduction to any electronic medium or machine readable form, in whole or part, is strictly prohibited, except for the express purpose for which it has been furnished, without prior written consent of Company. Watson Bowman Acme and its subsidiaries and affiliates ("We") and our licensors ("Licensor") shall retain all rights in and to the Materials, including without limitation, all intellectual property rights. No warranty, express or implied, is made by Company or its subsidiaries and affiliates, concerning products, or the use of products in specific situations ("Advice") is given by Company and is used at the Users own risk.



Flush Condition

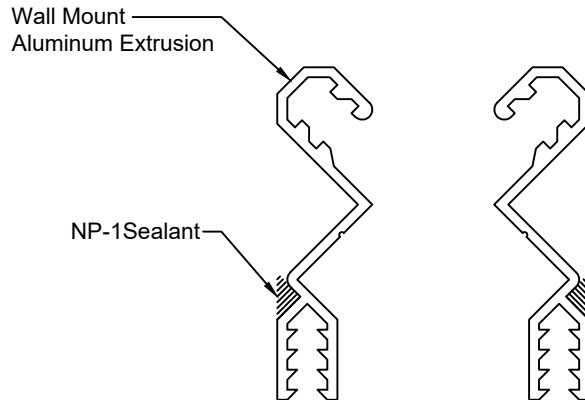

1

- Apply continuous bead of NP-1 Sealant along back of the aluminum extrusions prior to installation. (exterior only)

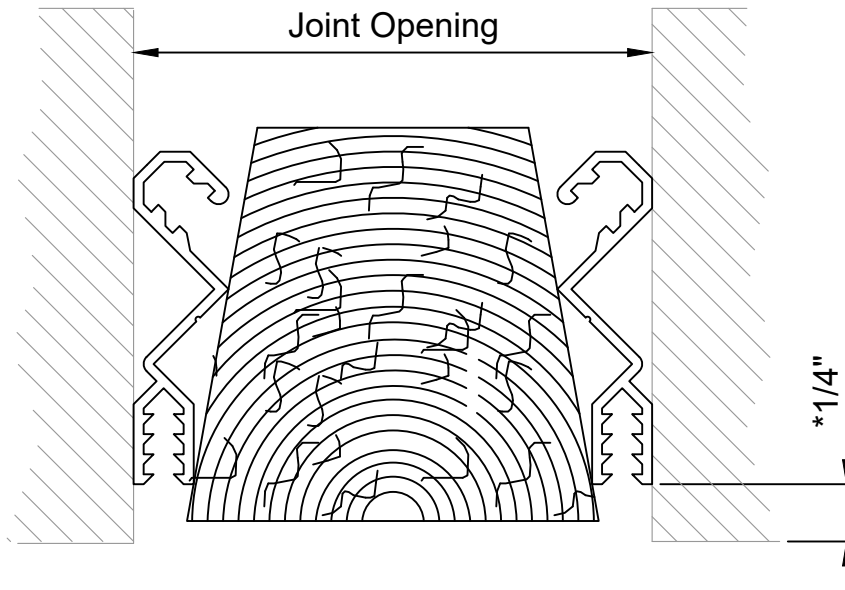

2

- Field measure all lengths and directional changes for aluminum extrusions to ensure their proper layout where required. Mount extrusions to wall surface and install temporary wood blocking to secure extrusions for field drilling operations. Wood blocking should be non-continuous to permit field drilling anchor holes at required spacing.

* Note: Always review architectural plans for specific project requirements

Sheet
2
of 6

Watson Bowman Acme
95 Pineview Drive Amherst, NY 14228
phone: (716) 691-7566 fax: (716) 691-9239
www.watsonbowmanacme.com

Installation procedure: WSW WeatherSeam system

Information provided herein, including but not limited to, any drawing, design, photograph, graphic, or statement(s) ("Materials") are proprietary and the property of Watson Bowman Acme ("Company"). Reproduction, translation, or reduction to any electronic medium or machine readable form, in whole or part, is strictly prohibited, except for the express purpose for which it has been furnished, without prior written consent of Company. All Materials contained herein are provided by Company for information purposes only. Company reserves the right to amend or withdraw any information contained in the Materials without notice. All technical or other advice by Company, whether verbal or written, concerning products, or the use of products in specific situations ("Advice") is given by Company and is used at the Users own risk.

**Watson
Bowman
Acme**

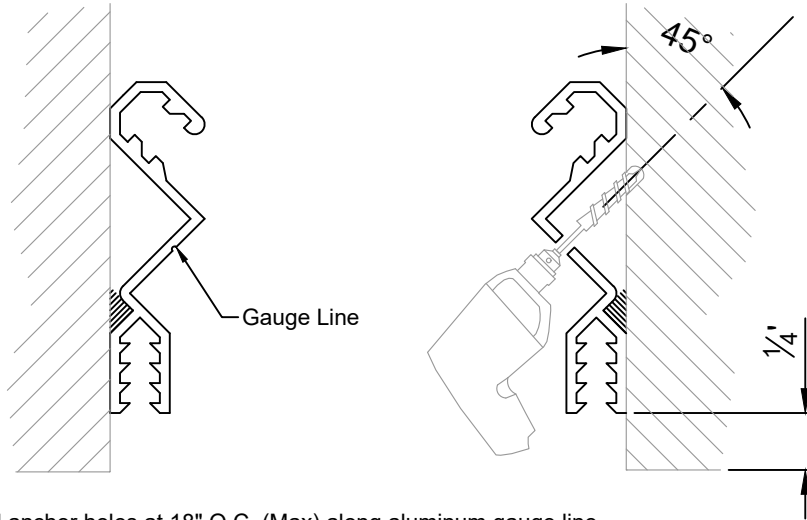

3

- Field drill anchor holes at 18" O.C. (Max) along aluminum gauge line.
Drill through aluminum into adjacent construction.

Note: All mortar joints in exterior walls must be flush with face of masonry to ensure tight weather seal.

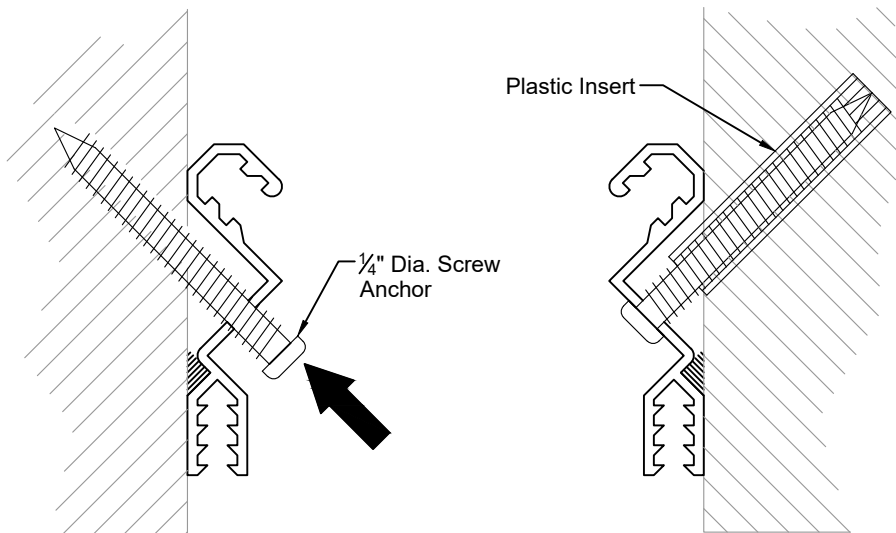

4

- Secure aluminum extrusions using appropriate anchors supplied by manufacturer.

Note: Utilize plastic inserts for securing Aluminum Extrusions to wall, if wall construction is either CMU or a Masonary wall.

Installation procedure: WSW WeatherSeam system

Information provided herein, including but not limited to, any drawing, design, photograph, graphic, or statement(s) ("Materials") are proprietary and the property of Watson Bowman Acme ("Company"). Reproduction, translation, or reduction to any electronic medium or machine readable form, in whole or part, is strictly prohibited, except for the express purpose for which it has been furnished, without prior written consent of Company. All Materials contained herein are provided by Company for information purposes only. Company reserves the right to amend or withdraw any information contained in the Materials without notice. Any use of the Materials without the written consent of Company, concerning products, or the use of products in specific situations ("Advice") is given by Company and is used at the Users own risk.

Installation procedure: WSW WeatherSeam system

Information provided herein, including but not limited to, any drawing, design, photograph, graphic, or statement(s) ("Materials") are proprietary and the property of Watson Bowman Acme ("Company"). Reproduction, translation, or reduction to any electronic medium or machine readable form, in whole or part, is strictly prohibited, except for the express purpose for which it has been furnished, without prior written consent of Company. All Materials contained herein are provided by Company for information purposes only. Company reserves the right to amend or withdraw any information contained in the Materials without notice and without liability. The use of the Materials is limited to the specific situations ("Advice") is given by Company and is used at the Users own risk.

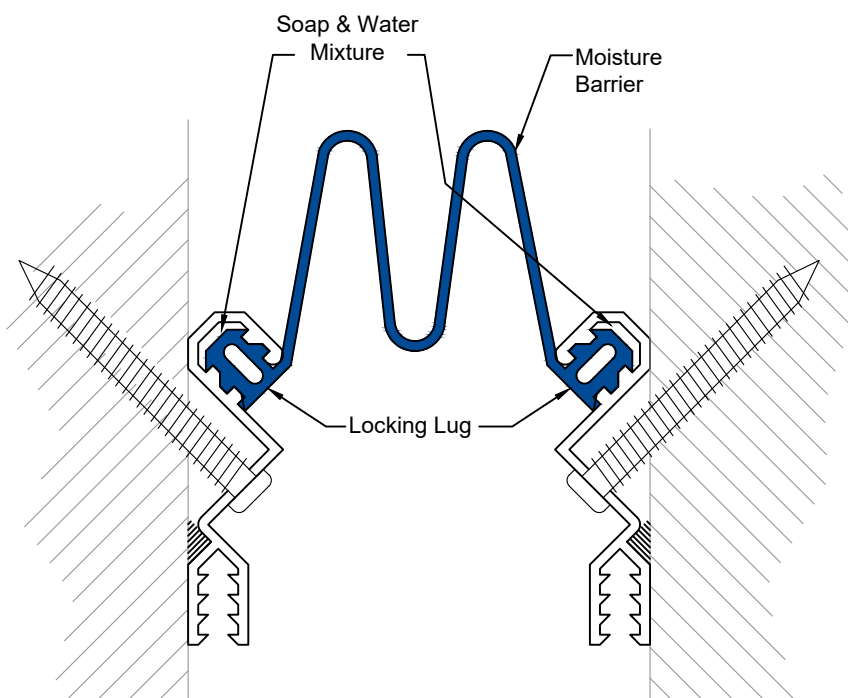

5

- Before installing Moisture Barrier spread a Soap & Water Mixture into cavities of Aluminum Extrusions. Ensure full engagement of locking lug.

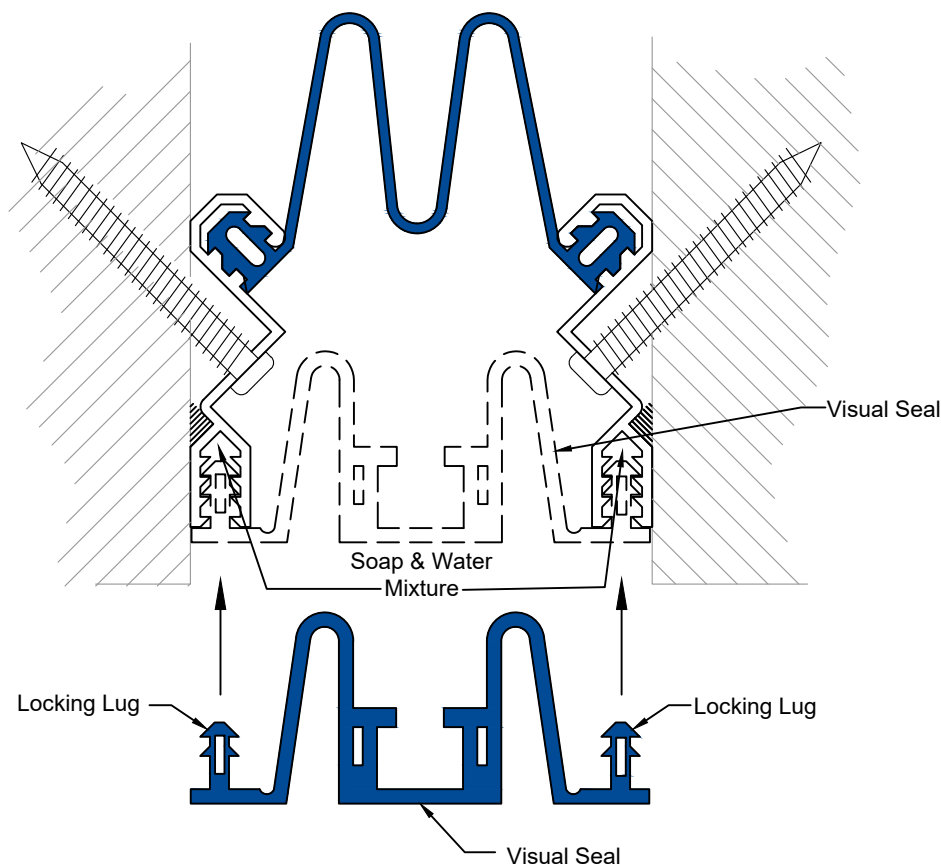

6

- Before installing Visual Seal spread a Soap & Water Mixture into cavities of Aluminum extrusions. Ensure full engagement of locking lug.

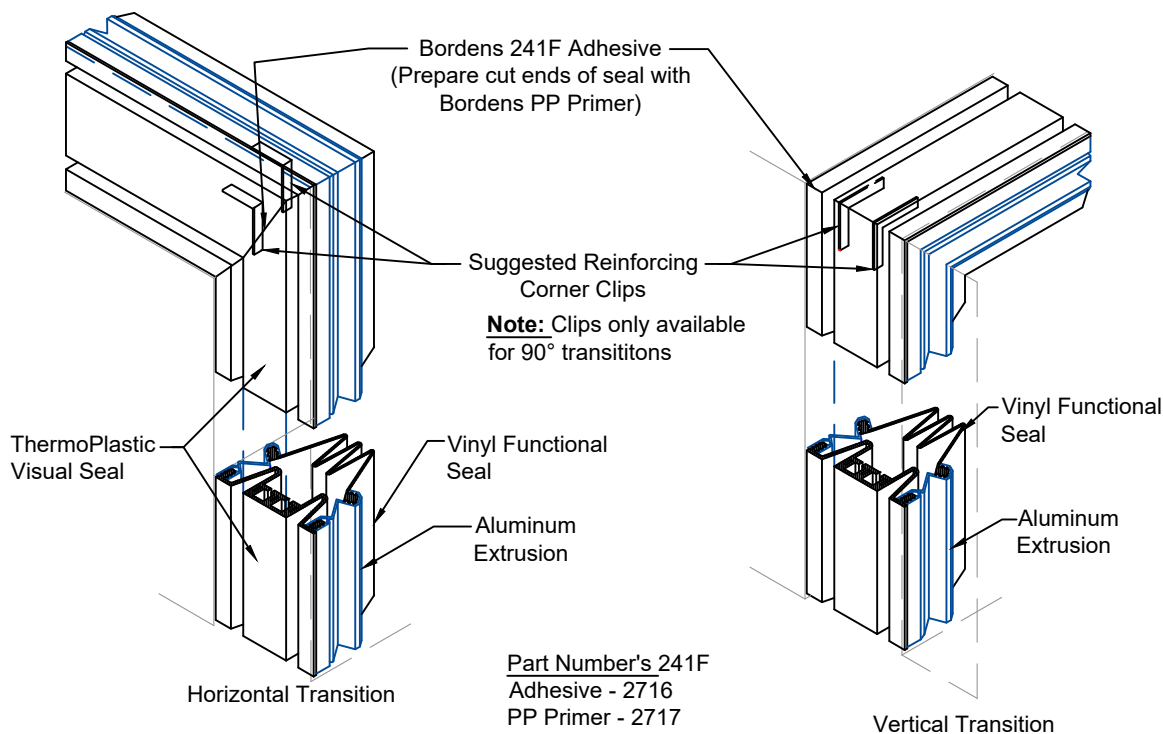

"WSW" Visual Seal Field Splice Procedures

Used for direction changes, Going around corners, Parapets, Etc
(Santoprene Only)

1. Cut ends of the WSW visual seal, with a sharp knife, to the desired angle using a formed jig with miter box (supplied by contractor). Insure cuts are clean, straight and square.
2. Cleans ends of seal with a solvent to remove any foreign material.
3. Brush apply PP Primer to both seal ends to be joined together at splice.
4. Reassemble mitered ends of adjacent seals utilizing the reinforcing corner clips (for 90° transitions only).
5. Apply Borden's 241F adhesive as specified by the manufacturer to one of the two seal surfaces to be bonded.
6. Apply pressure bringing the two surfaces in tight contact immediately upon completing application of the adhesive. Hold in place for approximately one to two minutes to allow adhesion.
7. Re-check quality of all miters or splices and apply additional adhesive if required to ensure proper miter or splice.
8. Contact manufacturer for clarification of above procedure (if required) prior to proceeding with splicing visual seal profile. It is usually recommended to allow 15 minutes time before installing spliced seal. Care shall be excercised as a result that it takes 24 hours for adhesive to fully cure.

Installation procedure: WSW WeatherSeam system

Information provided herein, including but not limited to, any drawing, design, photograph, graphic, or statement(s) ("Materials") are proprietary and the property of Watson Bowman Acme ("Company"). Reproduction, translation, or reduction to any electronic medium or machine readable form, in whole or part, is strictly prohibited, except for the express purpose for which it has been furnished, without prior written consent of Company. All Materials contained herein are provided by Company for information purposes only. Company reserves the right to amend or withdraw any information contained in the Materials without notice. All technical or other advice by Company, whether verbal or written, concerning products, or the use of products in specific situations ("Advice") is given by Company and is used at the Users own risk.

**Watson
Bowman
Acme**

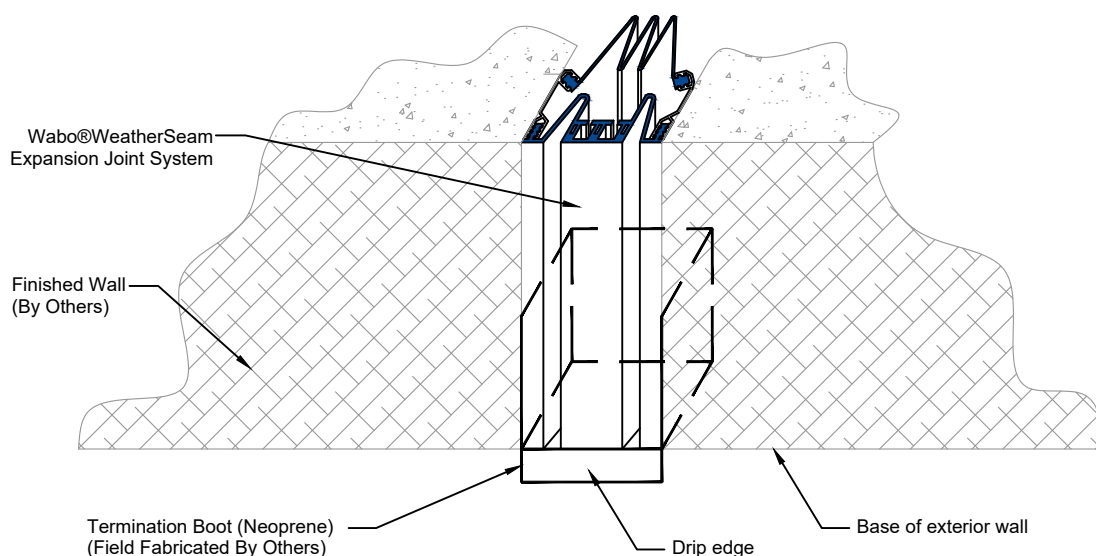

"WSW" Termination Detail

Can be used at the base of the WSW Seal Installation

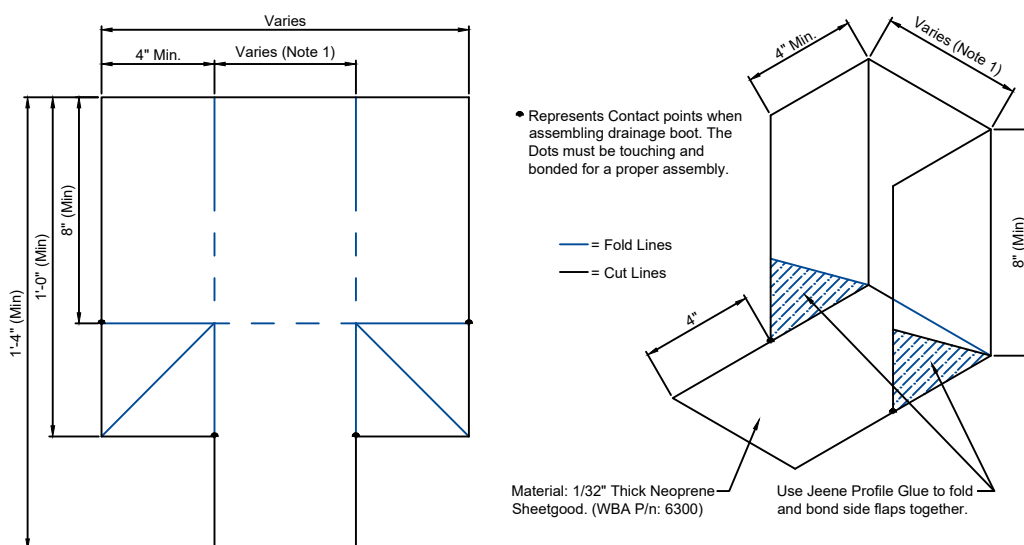

Notes:

1. Overall width of Boot Transition will be determined on the amount of movement the WSW system can accommodate during normal movement ranges. WBA suggests that the dimension will be at least Maximum Opening plus 1". This is to ensure that there will not be any damage to the boot while the system is at maximum opening.

Installation procedure: WSW WeatherSeam system

Information provided herein, including but not limited to, any drawing, design, photograph, graphic, or statement(s) ("Materials") are proprietary and the property of Watson Bowman Acme ("Company"). Reproduction, translation, or reduction to any electronic medium or machine readable form, in whole or part, is strictly prohibited except for the express purpose for which it has been furnished, without prior written consent of Company. All Materials contained herein are provided by Company for information purposes only. Company reserves the right to amend or withdraw any information contained in the Materials without notice. All technical or other advice by Company, whether verbal or written, concerning products, or the use of products in specific situations ("Advice") is given by Company and is used at the Users own risk.