

BITUTHENE[®] Mastic (US Version)

One part gun or trowel applied mastic for sealing Bituthene membrane terminations and details

Product Description

BITUTHENE[®]Mastic is a rubberized, asphalt-based mastic. It has excellent adhesion to structural concrete, masonry and wood. The VOC (Volatile Organic Compound) content is 225 g/L. Architectural and industrial maintenance regulations limit the VOC content in products classified as architectural coatings. Refer to Technical Letters for the most current list of allowable limits. BITUTHENE[®]Mastic is available in tubes or pails.

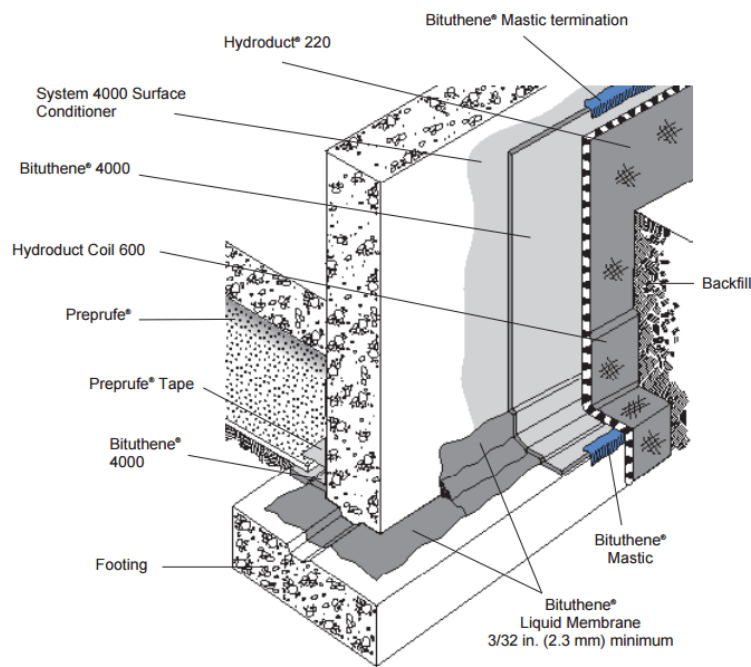

Product Advantages

- Excellent adhesion
- Seals terminations, edges of patches and overlaps in detail areas

Use

BITUTHENE[®]Mastic is designed to seal terminations, edges of patches and overlaps in detail areas. On vertical applications, the mastic must be applied to both the top and bottom terminations.

Limitation

BITUTHENE®Mastic is an integral part of the BITUTHENE®waterproofing system. This mastic should not be applied where it will be covered with BITUTHENE®waterproofing membrane, except as permitted as a temporary cutoff. It should not be used as a primary waterproofing material.

Application Procedures

Safety, Storage and Handling Information

BITUTHENE®products must be handled properly. Vapors from solvent based primers and mastic are harmful and flammable. For these products, the best available information on safe handling, storage, personal protection, health and environmental considerations has been gathered. SDS (Safety Data Sheet) are available on the web site and users should acquaint themselves with this information. Carefully read detailed precaution statements on product labels and the SDS before use.

Application

Apply BITUTHENE®Mastic either with a caulking gun or trowel. If applied with a caulking gun, level the bead with a trowel to about 0.125 in. (3 mm) thickness and 0.5 in. (13 mm) to 1 in. (25 mm) width. When applied as a temporary cutoff, trowel BITUTHENE®Mastic to 0.060 in. (1.5 mm) thickness. BITUTHENE®waterproofing membrane may be placed over the thin cutoff the next day.

On the bottom edge of vertical applications, BITUTHENE®Mastic should be troweled upward. Use it liberally at membrane terminations.

Material usage requirements for BITUTHENE®Mastic will vary widely from job to job. On large horizontal plaza areas with few protrusions, only about one quarter of a tube may be required per roll of membrane. A vertical application may require one half tube or more per roll of membrane. Applications involving other protrusions may require one or more tubes per roll.

Clean tools with mineral spirits at the end of each day. Mineral spirits is a combustible liquid and should be used only in accordance with the manufacturer's safety recommendations. **Do not use solvents to clean hands or skin.**

Supply

| BITUTHENE® PROPERTY | TUBE VALUE | PAIL VALUE |
|---------------------|--|---|
| Unit size | 30 oz (.9 L) tube | 5 gal (18.9 L) pail |
| Packaging | 12 tubes/carton | 36 pails/pallet |
| Weight | 33 lbs (15 kg)/carton | 54 lbs (24 kg)/pail |
| Coverage | 1 tube—65 linear feet (20 m) [0.25 in. (6 mm) x 0.25 in. (6 mm) bead] | 100 linear ft/gal (8.1 m/L) [1 in. (25 mm) wide troweling] |

gcpat.com | North America customer service: 1-866-333-3726

We hope the information here will be helpful. It is based on data and knowledge considered to be true and accurate, and is offered for consideration, investigation and verification by the user, but we do not warrant the results to be obtained. Please read all statements, recommendations, and suggestions in conjunction with our conditions of sale, which apply to all goods supplied by us. No statement, recommendation, or suggestion is intended for any use that would infringe any patent, copyright, or other third party right.

BITUTHENE is a trademark, which may be registered in the United States and/or other countries, of GCP Applied Technologies Inc. This trademark list has been compiled using available published information as of the publication date and may not accurately reflect current trademark ownership or status.

© Copyright 2018 GCP Applied Technologies Inc. All rights reserved.

GCP Applied Technologies Inc., 62 Whittemore Avenue, Cambridge, MA 02140 USA.

In Canada, 294 Clements Road, West, Ajax, Ontario, Canada L1S 3C6.

This document is only current as of the last updated date stated below and is valid only for use in the United States. It is important that you always refer to the currently available information at the URL below to provide the most current product information at the time of use. Additional literature such as Contractor Manuals, Technical Bulletins, Detail Drawings and detailing recommendations and other relevant documents are also available on www.gcpat.com. Information found on other websites must not be relied upon, as they may not be up-to-date or applicable to the conditions in your location and we do not accept any responsibility for their content. If there are any conflicts or if you need more information, please contact GCP Customer Service.

Last Updated: 2021-02-05

gcpat.com/solutions/products/bituthene-post-applied-waterproofing/bituthene-mastic