

# POLYUREA PUMPS

## DUAL COMPONENT PUMP ACCESSORIES

### TANK WARMERS (SET OF 2)



Specifications	
Part Number	Description
SX20017	5 Gallon Pail Warming Heater Wrap

### 6.5 GALLON TANK



Specifications	
Part Number	Description
SX20005 - 5POLYOL	6.5 Gallon Resin Tank
SX20005- 5ISO	6.5 Gallon Hardener Tank

### STATIC MIXER NUT

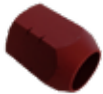

Specifications	
Part Number	Description
SX20111	Static Mixer Retaining Nut

### 2:1 RATIO KIT



Specifications	
Part Number	Description
SX21000	2:1 Ratio Kit for the Dual Component Pump
SX21300	2:1 Ratio Kit for the One Man Pump

### REPLACEMENT PUMP

NEW



Specifications	
Part Number	Description
SX20205	Replacement Fluid Pump

### HOSE WITH FITTINGS



Specifications	
Part Number	Description
SX20410	Steel Braided Hose

### FLOOR SCRAPER



Specifications	
Part Number	Description
CTHD-S0305ERG	5" Floor Scraper with 5' Ergonomic Handle

### TANK KIT



Specifications	
Part Number	Description
SX20065	6.5 Gallon Tank Kit
*Includes: (2) Tanks, (2) Lids, Support Cables and Debris Screens	

### STATIC MIXER



Specifications	
Part Number	Description
SX20010-20	Pack of 20 Static Mixers
SX20010-100	Pack of 100 Static Mixers

### STATIC MIXER CAP



Specifications	
Part Number	Description
SX20012	Manifold Night Cap

### PUMP SEAL KIT



Specifications	
Part Number	Description
SX20201-1	Pump Seal Kit

### MANIFOLD KIT



Specifications	
Part Number	Description
SX20116	Dispensing Manifold Kit

### POWER INVERTER



Specifications	
Part Number	Description
SX20023	1200W Pure Sine Wave Power Inverter

### SCRAPER BLADE



Specifications	
Part Number	Description
CTHDS-03BL50	Pack of 50 5" Scraper Blades
CTHDS-03BL100	Pack of 100 5" Scraper Blades