



Installation Procedure

Watson Bowman Acme 95 Pineview Drive Amherst, NY 14228

phone: (716) 691-7566 fax: (716) 691-9239

www.watsonbowmanacme.com

Information provided herein, including but not limited to, any drawing, design, photograph, graphic, or statement(s) ("Materials") are proprietary and the property of Watson Bowman Acme Corporation. Reproduction, translation, or reduction to any electronic medium or machine readable form, in whole or part, is strictly prohibited, except for the express purpose for which it has been furnished, without prior written consent of Company. All Materials contained herein are provided by Company for information purposes only. Company reserves the right to amend or withdraw any information contained in the Materials without notice. All technical or other advice by Company, whether verbal or written, concerning products, or the use of products in specific situations ("Advice") is given by Company and is used at the Users own risk.

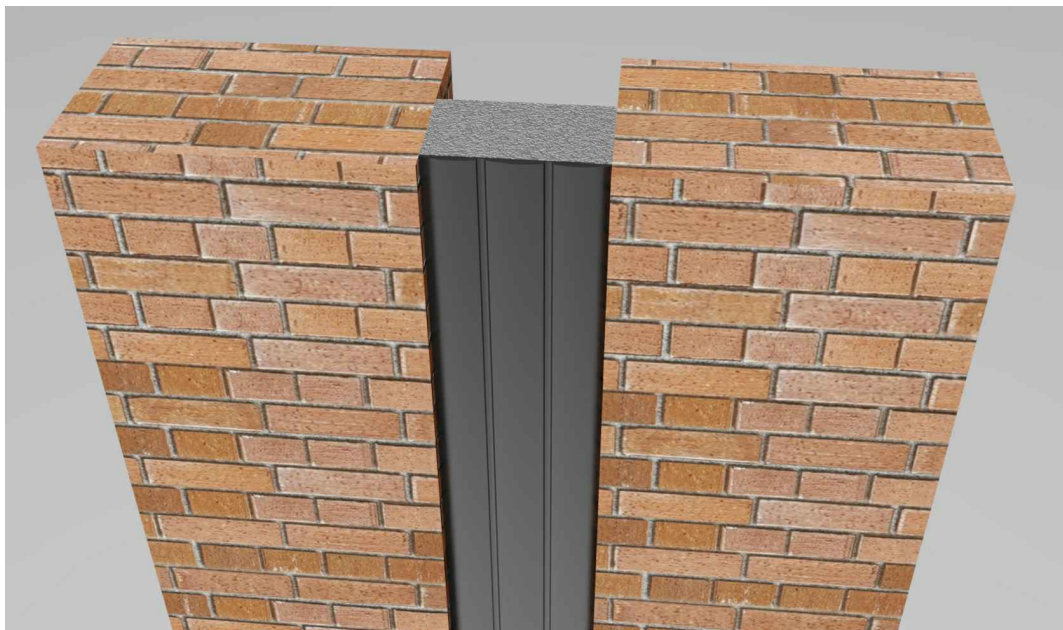

Wabo[®] WeatherSeal II Model(s) "WS" Vertical Expansion Control Systems

The following installation procedure is very important and must be fully understood prior to beginning any work. To ensure proper installation and performance of expansion joint system the following actions must be completed by the installing contractor. **Failure to do so will affect product warranty.**

- 1) Carefully read and understand installation procedure. Contact WBA's Technical Service Department at (800) 677-4922 for product assistance.
- 2) Inspect all shipments and materials for missing or damaged components and hardware. Contact Customer Service at (800) 677-4922 with WBA's order number and invoice for prompt assistance.
- 3) Inspect substrate or adjacent construction for acceptance before beginning work. Report unacceptable construction to the project manager for scheduled repair work.
- 4) Review WBA shop drawings for project specific detailed information if Engineering services were purchased at time of order.

Standard Components

Sheet

1
of 7

Watson Bowman Acme
95 Pineview Drive Amherst, NY 14228
phone: (716) 691-7566 fax: (716) 691-9239
www.watsonbowmanacme.com

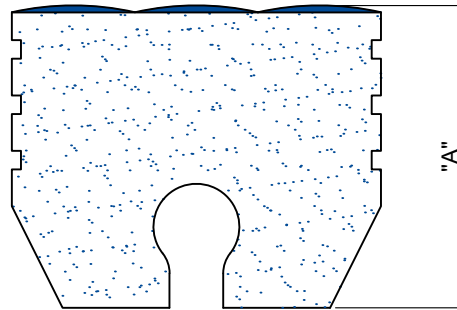

"WS" Seal
(Refer to chart below for
size and part number)

* - Length shown is approximate. Exact
lengths may deviate from length shown.

| Model | P/n for Colors Below | | | | "A" | Length * | Flexible Sealant Tube | Silicone 790 |
|--------|----------------------|-------|----------|---------------|--------|----------|--------------------------|-----------------|
| | Precast White | Gray | Charcoal | Natural Stone | | | | |
| WS-100 | 10401 | 10402 | 10403 | 10404 | 1 1/2" | 5' | 80065 | 80080-92 |
| WS-150 | 10405 | 10406 | 10407 | 10408 | 2" | 5' | 80065 | 80080-92 |
| WS-200 | 10409 | 10410 | 10411 | 10412 | 2" | 5' | 80065 | 80080-92 |
| WS-250 | 10413 | 10414 | 10415 | 10416 | 2" | 5' | 80065 | 80080-92 |
| WS-300 | 10417 | 10418 | 10419 | 10420 | 2 1/2" | 5' | 80065 | 80080-92 |
| WS-350 | 10421 | 10422 | 10423 | 10424 | 2 1/2" | 5' | 80065 | 80080-92 |
| WS-400 | 10425 | 10426 | 10427 | 10428 | 2 1/2" | 5' | 80065 | 80080-92 |
| WS-500 | 10429 | 10430 | 10431 | 10432 | 4" | 5' | 80065 | 80080-92 |

| Model | P/n for Colors Below | | | | "A" | Length * | Flexible Sealant Tube | Silicone 790 |
|--------|----------------------|-------|----------|---------------|-----|----------|--------------------------|-----------------|
| | Precast White | Gray | Charcoal | Natural Stone | | | | |
| WS-600 | 10441 | 10442 | 10443 | 10444 | 4" | 5' | 80065 | 80080-92 |

For 6" and Larger,
the following is also
required



Two Part Epoxy Adhesive
Part A = WBA P/N: #80050
Part B = WBA P/N: #80051

Components shown vary in size depending on model of system



Flexible Sealant Tube
#80065
(10.1oz Tube for 5ft)



Silicone 790
#80080-92
(1 Tube for 40ft)

Installation procedure: WS WeatherSeal II system

Information provided herein, including but not limited to, any drawing, design, photograph, graphic, or statement(s) ("Materials") are proprietary and the property of Watson Bowman Acme Corporation. Reproduction, translation, or reduction to any electronic medium or machine readable form, in whole or part, is strictly prohibited, except for the express purpose for which it has been furnished, without prior written consent of Company. All Materials contained herein are provided by Company for information purposes only. Company reserves the right to amend or withdraw any information contained in the Materials without notice. All technical or other advice by Company, whether verbal or written, concerning products, or the use of products in specific situations ("Advice") is given by Company and is used at the Users own risk.

**Watson
Bowman
Acme**

A. Clean and Prepare Joint Substrate

Concrete:

- Prior to beginning work, installer shall inspect and verify that the joint is clean, sound and will provide an appropriate surface (depth) for the installation of the Wabo® WeatherSeal II. Installer shall verify that the joint is uniform and that any spalls are repaired using proper materials and methods. Joint faces must be parallel.
- Confirm joint substrate is dry, clean and ready for the epoxy adhesive.

Metal:

- Confirm that the metal is clean and ready for the epoxy adhesive. Solvent wipe the substrate just prior to applying the epoxy.
- Ensure that there is no rust or loose paint on metal substrates before the epoxy is applied.

B. Mask Joint & Mixing Epoxy Adhesive

(6" size or Larger Only)

- Before installation of Wabo® WeatherSeal II tape off edges of the substrate to prevent the epoxy from coming into contact with the exposed surface.

Mix Epoxy

1. Epoxy adhesive may be used in the >40°F (5°C) to 95°F (35°C) temperature range.
2. Transfer the contents of Part B (hardener) into the contents of Part A (base). Always add Part B to Part A in a 1:1 ratio.
3. Mix the material thoroughly with a low speed drill (300rpm) and mixing paddle. Scrape the walls and bottom of the container to ensure uniform and complete mixing with no streaks. Failure to scrape all the contents out of the containers will cause you not to get the required yield out of each unit.
4. Important: Do not thin the epoxy.

TIPS

1. Mix only the required amount of epoxy that will be used within 20-30 minutes to prevent the epoxy from curing prematurely.
2. Mix equal parts of A & B for at least 3 minutes until the material is a uniform gray color.
3. Epoxy will not cure when the temperature is below 40°F.
4. For every +17°F, the epoxy cures twice as fast.
5. For every -17°F, the epoxy cures twice as long to cure.

Sheet
2
of 7

Watson Bowman Acme
95 Pineview Drive Amherst, NY 14228
phone: (716) 691-7566 fax: (716) 691-9239
www.watsonbowmanacme.com

Installation procedure: WS WeatherSeal II system

Information provided herein, including but not limited to, any drawing, design, photograph, graphic, or statement(s) ("Materials") are proprietary and the property of Watson Bowman Acme Corporation. Reproduction, translation, or reduction to any electronic medium or machine readable form, in whole or part, is strictly prohibited, except for the express purpose for which it has been furnished, without prior written consent of Company. Materials contained herein are provided by Company for informational purposes only. Company reserves the right to amend or withdraw any information contained in the Materials without notice. Use of the Materials without the written consent of Company constitutes a breach of contract. Company is not responsible for any situations ("Adverse") is given by Company and is used at the Users own risk.

**Watson
Bowman
Acme**

C. Apply Epoxy to Substrate, Unwrap Material

(6" size or Larger Only)

1. Mix only the required amount of epoxy that will be used within a 30 minute time frame to prevent the epoxy from curing prematurely.
2. **WARNING:** Epoxy will harden more quickly when left in the pot. Apply mixed epoxy onto the joint face as soon as possible.
3. **IMPORTANT:** The epoxy must still be uncured and tacky when installing the expansion joint sealant into the joint.
4. If the epoxy cures before installing the Wabo®WeatherSeal II, new epoxy can be reapplied within 2 hours.
5. After 2 hours, the substrate must be abraded to eliminate the amine blush that occurs in the final cure.
6. **IMPORTANT:** While others are applying the epoxy to the joint faces, others must prepare the Wabo®WeatherSeal II. The foam should be kept under compression in the original packaging until immediately needed.
7. Cut the plastic packing by cutting on the side with the hardboard and remove hardboard and inner liner. DO NOT cut along the silicone face.
8. After cutting the shrink wrap, work quickly to avoid the material expanding beyond a usable size. Do not pull or twist the material to avoid tearing the release liner.
9. Apply epoxy to ensure contact with full height of Wabo®WeatherSeal II expansion joint system profile.

Installation Procedure

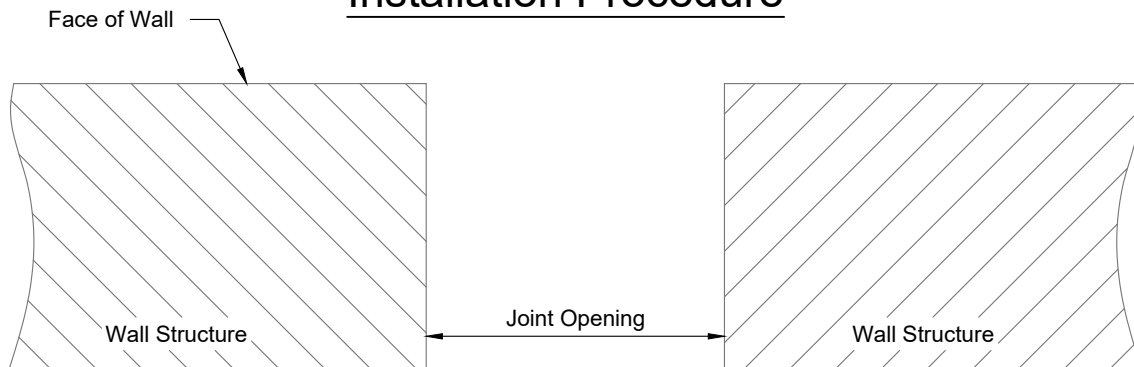

| Model | Joint Opening |
|--------|---------------|
| WS-100 | 1" |
| WS-150 | 1 1/2" |
| WS-200 | 2" |
| WS-250 | 2 1/2" |
| WS-300 | 3" |
| WS-350 | 3 1/2" |
| WS-400 | 4" |
| WS-500 | 5" |
| WS-600 | 6" |

1

Prior to beginning work, installer shall inspect for proper wall construction and ensure that joint opening has enough depth to accept Wabo®WeatherSeal II. Verify joint opening as called for on chart. Deficiencies in joint opening must be corrected prior to beginning work, such as spalled edges and protruding objects to ensure a clean, smooth, dry surface for installation of Wabo®Weatherseal II.

Sheet
3
of 7

Watson Bowman Acme
95 Pineview Drive Amherst, NY 14228
phone: (716) 691-7566 fax: (716) 691-9239
www.watsonbowmanacme.com

Installation procedure: WS WeatherSeal II system

Information provided herein, including but not limited to, any drawing, design, photograph, graphic, or statement(s) ("Materials") are proprietary and the property of Watson Bowman Acme Corporation. Reproduction, translation, or reduction to any electronic medium or machine readable form, in whole or part, is strictly prohibited, except for the express purpose for which it has been provided. No part of this document may be reproduced, stored in a retrieval system, or transmitted in any form or by any means, electronic, mechanical, photocopying, recording, or by any information storage and retrieval system, without prior written permission from Watson Bowman Acme Corporation. All technical or other advice by Company, whether verbal or written, concerning products, or the use of products in specific situations ("Advice") is given by Company and is used at the Users own risk.

**Watson
Bowman
Acme**

Installation Procedure

(For sizes up to 5-3/4")

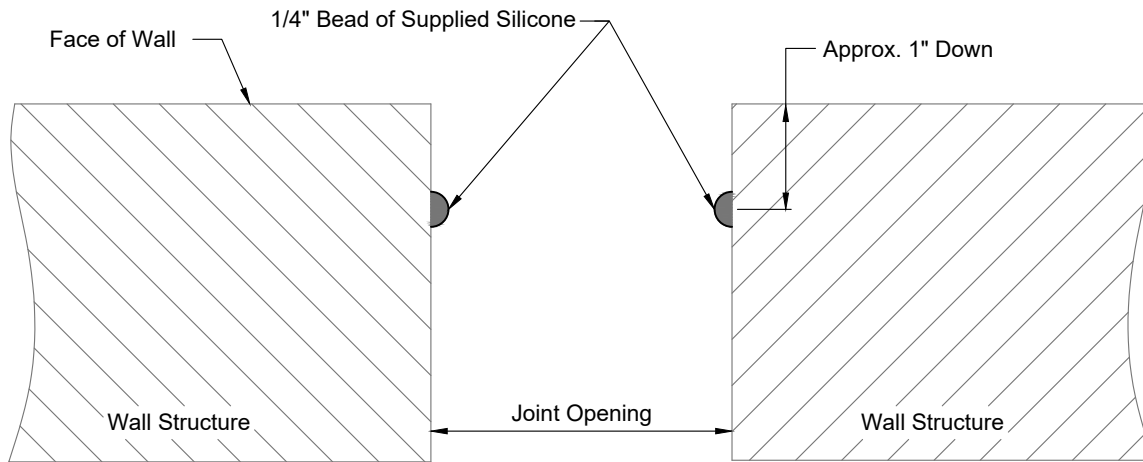

2a

Before installation of Wabo®WeatherSeal II, apply a 1/4" bead of Color matched Silicone Sealant on the inside face of the Joint Opening.

Installation Procedure

(For sizes 6" and larger")

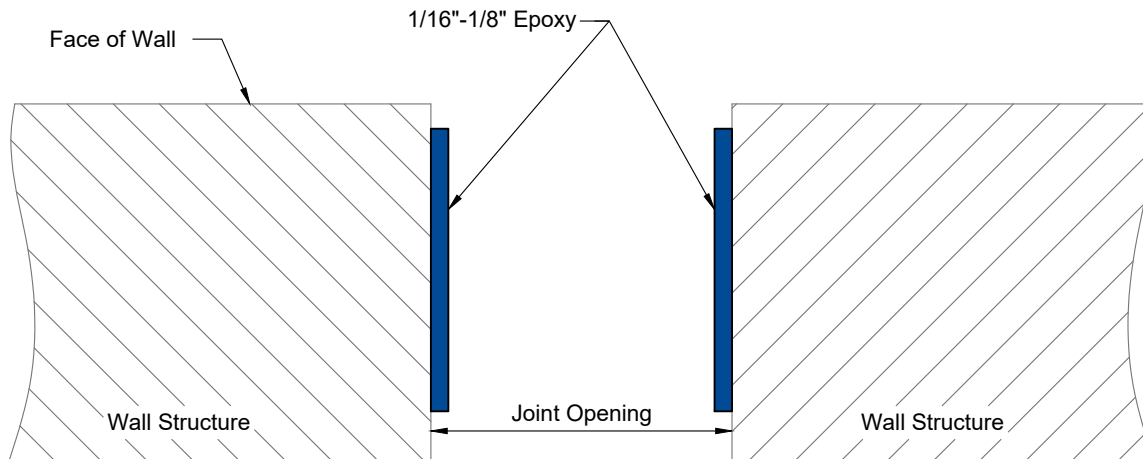

2b

Apply a 1/16" - 1/8" coating of epoxy to both sides of the joint substrate using a 1" margin trowel (or gloved hand) to the depth of the foam. The epoxy must still be wet upon the installation of the Wabo®WeatherSeal II.

Sheet
4
of 7

Watson Bowman Acme
95 Pheview Drive Amherst, NY 14228
phone: (716) 691-7566 fax: (716) 691-9239
www.watsonbowmanacme.com

Installation procedure: WS WeatherSeal II system

Information provided herein, including but not limited to, any drawing, design, photograph, graphic, or statement(s) ("Materials") are proprietary and the property of Watson Bowman Acme Corporation. Reproduction, translation, or reduction to any electronic medium or machine readable form, in whole or part, is strictly prohibited, except for the express purpose for which it has been furnished, without prior written consent of Company. All Materials contained herein are provided by Company for information purposes only. Company reserves the right to amend or withdraw any information contained in the Materials without notice. All technical or other advice by Company, whether verbal or written, concerning products, or the use of products in specific situations ("Advice") is given by Company and is used at the Users own risk.

**Watson
Bowman
Acme**

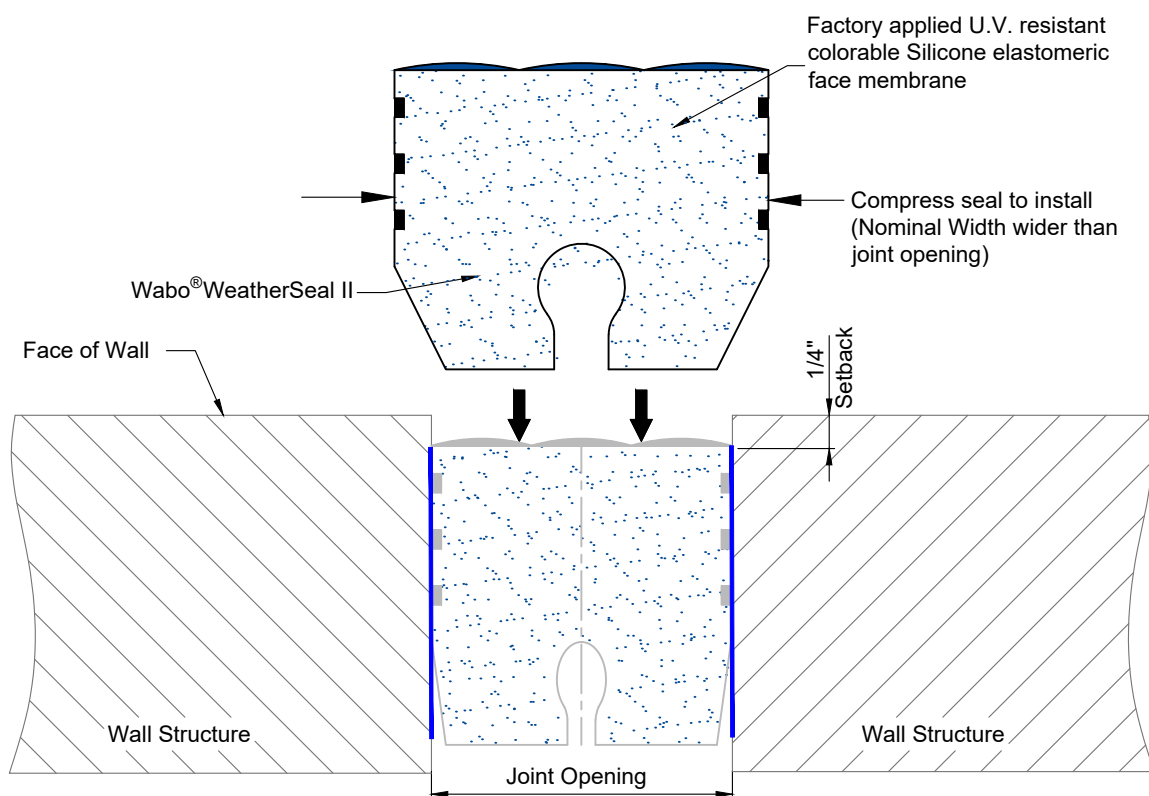

3

Compress Wabo®WeatherSeal II and push into joint opening with Silicone covering facing outward. Once Seal is normally installed to a correct setback depth of 1/4" from outside face of wall.

Note:

Utilizing the supplied color matched Silicone, apply a bead of sealant along inside face of joint opening before installation of Wabo®WeatherSeal II.

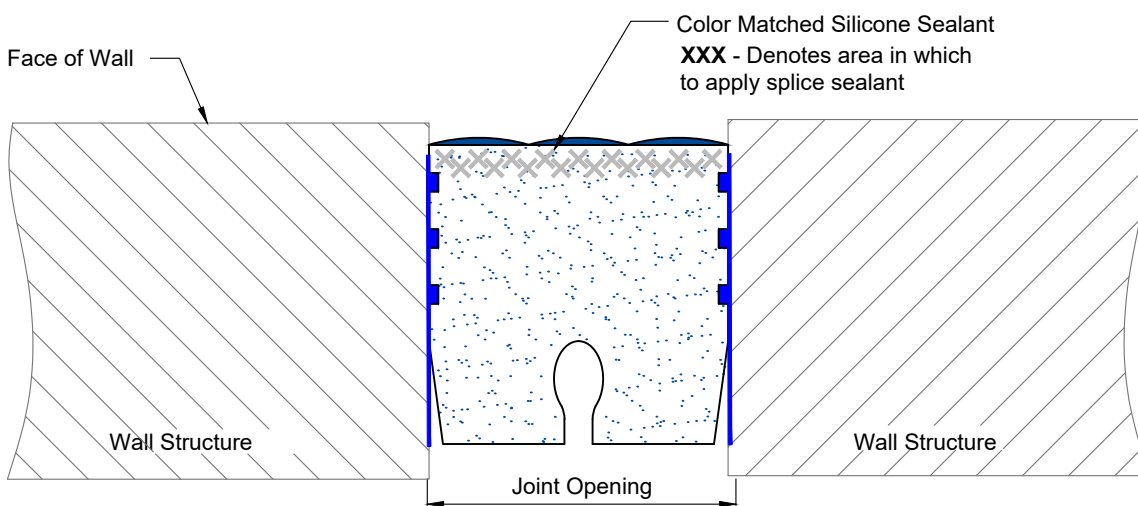

4

Continued on next page...

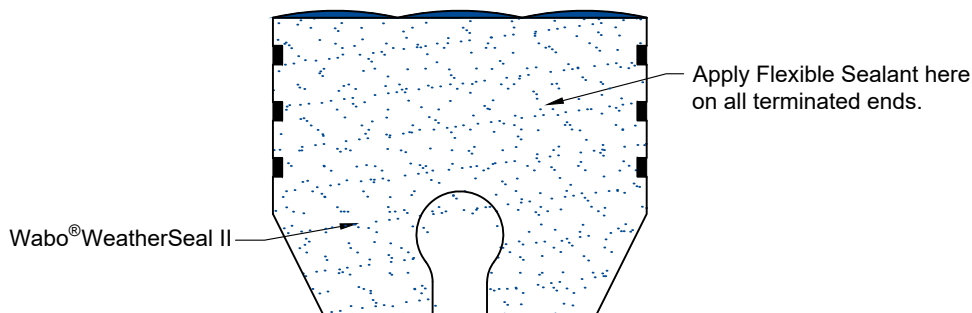

4A

IMPORTANT NOTE:

At all exposed terminated ends (including any and all Factory Transitions), apply a liberal coat of Clear Flexible Sealant to the entire surface of the Foam terminated end(s). Doing so will ensure proper moisture resilience. Do not coat faces of the Wabo®WeatherSeal II with the Clear Flexible Sealant that will come in contact with epoxy.

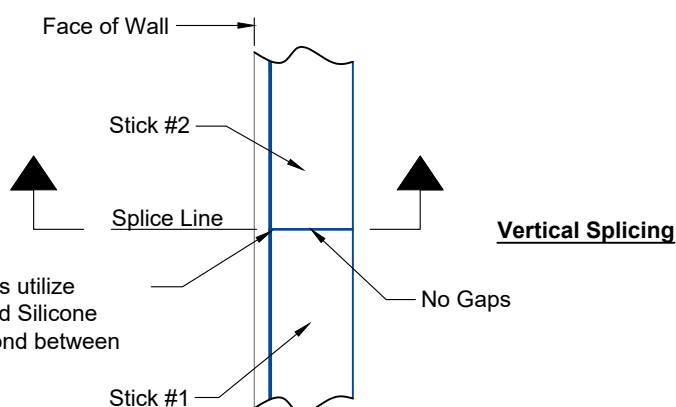

Note: At splice locations utilize Supplied Color Matched Silicone Sealant to provide a bond between seal sticks.

At all splice locations, apply a bead of Color Matched Silicone Sealant at the exposed edge of the Wabo®WeatherSeal II. This is to ensure a proper bond between the factory applied Silicone on each seal stick.

5

Notes:

1. After the Silicone Sealant has been installed, repeat installation of Wabo®WeatherSeal II starting from Step 2. Exercise caution so that there are no gaps between each seal stick section during installation.
2. After installation of each stick, tool the splice location smooth using additional supplied silicone if necessary. This will provide a finished surface and hide the splice location as well.

Horizontal Directional Change at Face of Building

Note: At splice locations utilize Supplied Color Matched Silicone Sealant to provide a bond between seal sticks.

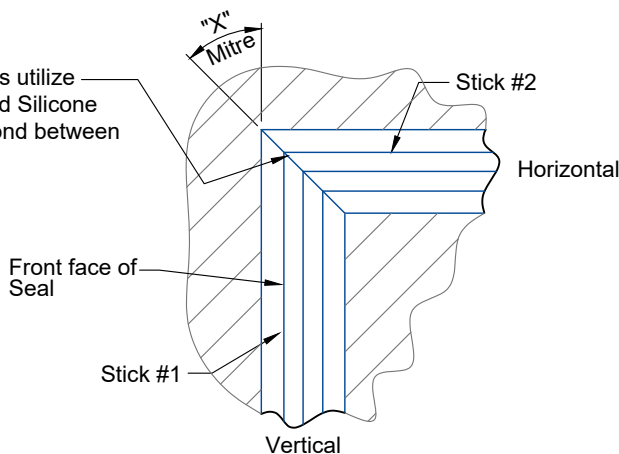

6

At a Horizontal Directional change at face of building, cut Wabo®WeatherSeal II to desired angle of transition.

Note: At directional change locations, follow Step 4 for finishing directions.

Vertical Directional Change at Top of Building wall/Parapet

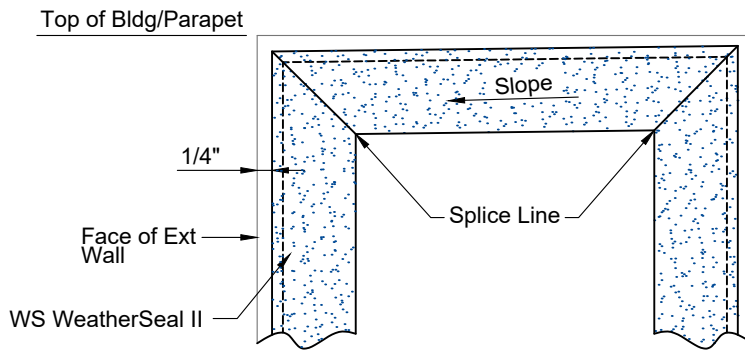

7

At parapet transition locations, cut Wabo®WeatherSeal II to the desired angle of transition.
Note: At directional change locations, follow Step 4 for finishing directions.

Sheet
7
of 7

Watson Bowman Acme
95 Pineview Drive Amherst, NY 14228
phone: (716) 691-7566 fax: (716) 691-9239
www.watsonbowmanacme.com

Installation procedure: WS WeatherSeal II system

Information provided herein, including but not limited to, any drawing, design, photograph, graphic, or statement(s) ("Materials") are proprietary and the property of Watson Bowman Acme Corporation. Reproduction, translation, or reduction to any electronic medium or machine readable form, in whole or part, is strictly prohibited, except for the express purpose for which it has been furnished, without prior written consent of Company. All Materials contained herein are provided by Company for information purposes only. Company reserves the right to amend or withdraw any information contained in the Materials without notice. All technical or other advice by Company, whether verbal or written, concerning products, or the use of products in specific situations ("Advice") is given by Company and is used at the Users own risk.

