

MISCELLANEOUS ANCHORS & ACCESSORIES

Slip-Set Stabilizer

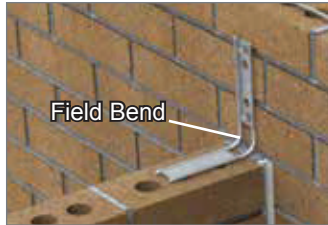

Slip-Set Stabilizer - Bonds masonry walls and restrains lateral movement while allowing expansion and control joints to perform as designed. Field bend to connect intersecting walls, or new walls to existing walls.

Finishes: Mill Galvanized, Hot Dipped Galvanized or Type 304 Stainless Steel with a loose PVC "Slip-Tube"

#344 Rigid Partition Anchor

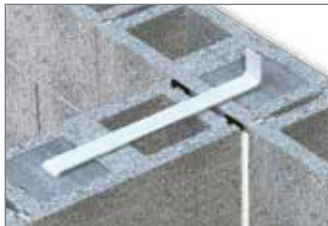

#344 - For anchoring load bearing walls at an intersection. Fabricated from 1/4" bar stock 1-1/2" wide per code ACI-530. Length is custom to job with 2" standard bends on each end.

Finishes: Hot Dipped Galvanized or Stainless Steel (Type 304 or 316).

CWT Corrugated Wall Tie

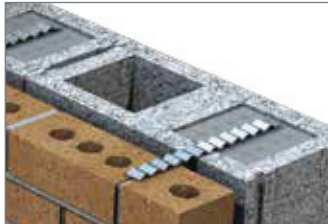

Manufactured from **99%** post industrial recycled material.

CWT - Standard - 22 ga., 18 ga., or 16 ga. thick x 7/8" wide x 7" long. Other sizes available upon request.

Finishes: Hot Dipped Galvanized or Stainless Steel Type 304.

CCJ Corrugated Control Joint

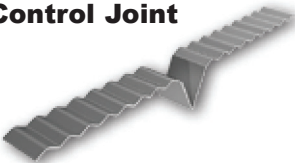

CCJ - Standard - 22 ga. thick X 7/8" wide X 7" overall length. V-Section is 1-3/4" deep.

Corrugated Control Joint Anchors allow the wall to expand and contract preventing concrete from cracking.

Finishes: Hot Dipped Galvanized or Stainless Steel.

Glass Block Panel Anchor



Glass Block Panel Anchor - Standard - 20 ga. thick x 1-3/4" wide x 24" or 16" long. Designed to anchor glass block to the adjacent structure.

Finishes: Hot-Dip Galvanized or Type 304 Stainless Steel.

MWT Mesh Wall Tie

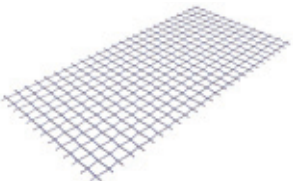

MWT - For bonding intersecting masonry walls. Conforms to ASTM A740.

Dimensions: 1/2" square by 16 ga. 3", 4", 6", 8", or 10" wide by 100' roll. Other sizes available upon request.

Finishes: Hot Dipped Galvanized (ASTM A 153) or Type 304 or Type 316 Stainless Steel (ASTM E 437).

MGS Mortar / Grout Screen

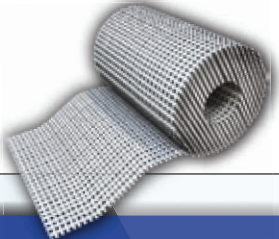

MGS - Monofilament screen is fabricated from high strength, non-corrosive polypropylene polymers. Isolates flow of grout in designated areas requiring reinforced concrete block. Also allows for greater bonding of masonry anchor in hollow block construction.

Dimensions: 1/4" square x 4", 6", 8", 10" or 12" wide x 100' rolls.